

BEAUFORT Max Vertical

- Type 11 & Type 20 profiles cloaked in 70mm flat tubed radiators
- Vertical format available in 1 height & 4 widths
- Standard White RAL 9016 delivered in 48-72 hours
- 25 RAL colours, 8 special finishes, up to 15 working days (page 11)



Sizes & Prices

Dimensions (mm)		Elements	Output Δt 50°C		Product Code
Height	Width		Watts	Btu's	
Vertical - Type 11					
1800	366	5	903	3081	BEAM18360511 ♦
	514	7	1268	4326	BEAM18510711
	588	8	1450	4947	BEAM18580811
	662	9	1632	5568	BEAM18660911
Vertical - Type 20					
1800	366	10	1105	3770	BEAM18361020
	514	14	1552	5295	BEAM18511420
	588	16	1775	6056	BEAM18581620
	662	18	1999	6821	BEAM18661820

Pipe Centres and Technical Drawings

Type 11



Type 20

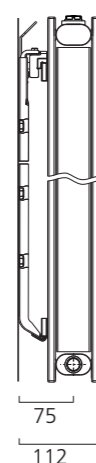

Type 11

Single flat tubed radiator with a single convector

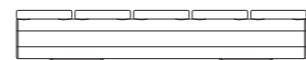

Pipe centres left to right = Width plus valves
 Pipe centres from wall = 63mm
 Depth from wall = 99mm

Type 20

Double flat tubed radiator (front and back)



Pipe centres left to right = Width plus valves
 Pipe centres from wall = 75mm
 Depth from wall = 112mm

+Valves Prices include Angled Chrome or White KINGSTON TRV's

Please specify at time of order



Horizontal (pg.36-37)



BEAUFORT Max Vertical Type 11

♦BEAUFORT Max Vertical Type 11 1800mm x 366mm in White RAL 9016 with White WELLINGTON TRV's.

BEAUFORT MAX Vertical Fitting Instructions

Type 11(K1) & Type 20 convectors cloaked in 70mm flat tubed radiators.

Please read these instructions and terms and conditions carefully prior to installation. Failure to do so may invalidate the warranty.

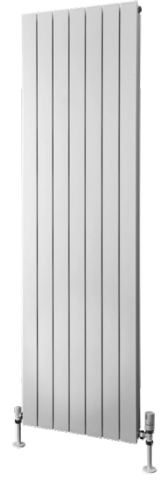

Fig 1

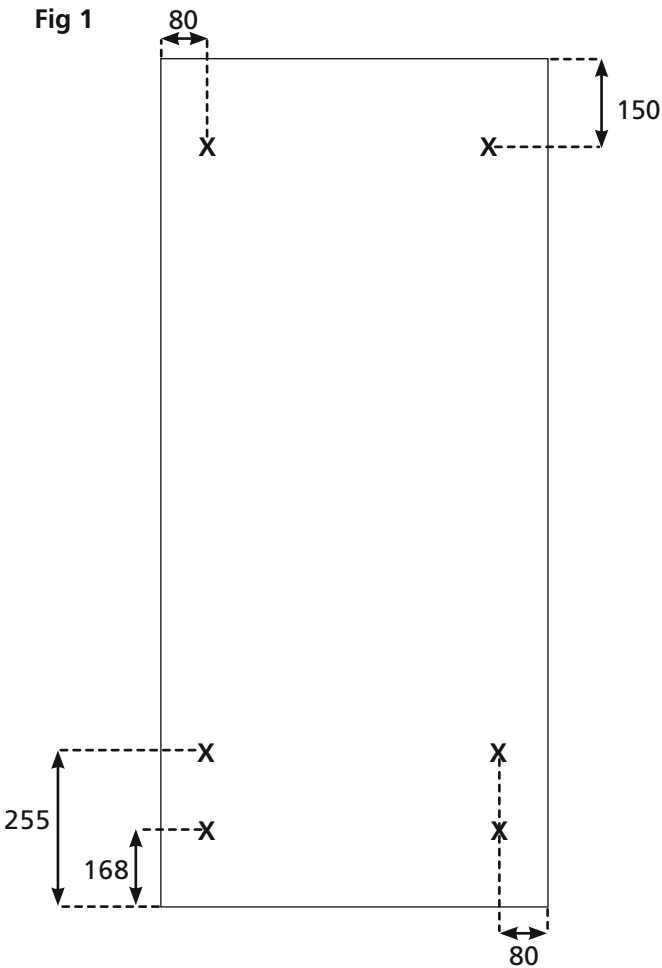
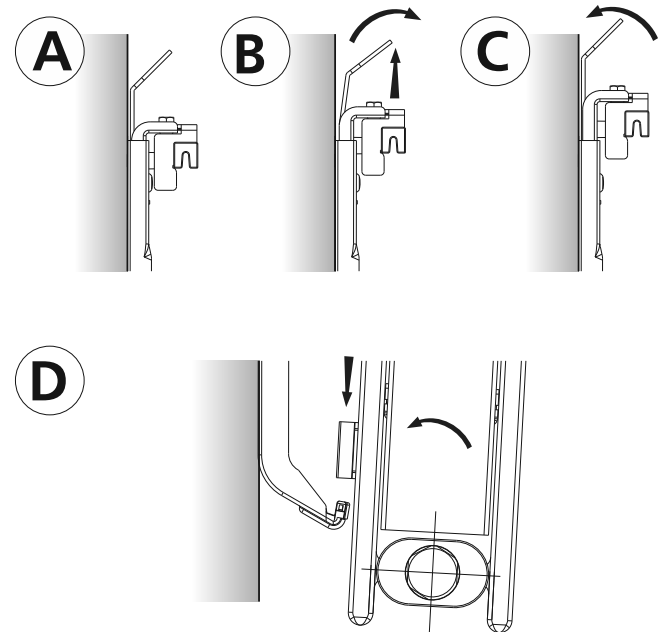

Fig 2



Pipe centres left to right	=	50mm
Pipe centres from wall	=	Type 11 = 63mm Type 20 = 75mm
Depth from wall	=	Type 11 = 99mm Type 20 = 112mm

1. Unpack & Inspect

This product should have reached you in perfect condition. Please carefully unpack and inspect this radiator and all fittings. Your point of purchase must be notified of any shortages or damage within 28 days of delivery. For further information please see terms and conditions on reverse.

2. Contents

You should have:

- 1 Radiator
- 2 Wall Brackets
- 7 Screws x 60mm
- Dowel plugs 10mm
- 4 Safety Catch against lifting
- 1 Manual Airvent
- 1 Blanking Plug
- Screws and Raw Plugs

You will need:

- Tape measure
- Electric drill and bits
- Spirit level
- Airvent key
- Appropriate wall fixings
- Spanners for airvents / valves

Cleaning: Steel products can be cleaned using a soft damp cloth with a non-abrasive cleaning product.

3. Installing radiator

1. Position the radiator against the wall in the desired position. Lightly mark either side and top of the radiator.
2. Mark up position of brackets at the desired height of the radiator referring to **Fig 1** top brackets measure 80mm in from each side of the radiator and 150mm down from the top of the radiator (Remember to add the desired height for hanging the radiator to the mark made whilst the radiator was standing against the wall). Bottom brackets have two fixing positions, the top part measuring 255mm up from the bottom of the radiator, the lower part 168mm up from the bottom of the radiator and 80mm in from each side. Using a spirit level mark on the vertical lines on bracket positions. Please note these measurements are for the fixing points of the brackets.
3. Fix brackets with suitable fixings
4. Once the brackets are fitted Refer to **Fig 2** on the top bracket "A" pull the lever forward "B" simultaneously lift the bracket. Release the lever "C" and this will lock the bracket into the higher position. Lift the radiator and at a slight angle and slot onto lower bracket "D". Move the radiator to a vertical position. Pull the lever on the top bracket and this will release top bracket from its upper position and it will lower to fix the top bracket. Repeat on both brackets.

4. Commission Radiator

Please Note: In accordance with Part L1 2006 of the Building Regulations and BS7593:1992 code of practice for the treatment of hot water and central heating systems, we strongly recommend flushing the heating system post installation of new radiators and then adding the correct quantity and type of inhibitor for use with your radiator and system to prevent corrosion. Damage caused to systems not protected by a suitable inhibitor will not be covered by manufacturer's guarantee.

Technical Specifications

Materials	Steel
Connections	½" flow and return.
Test pressure	13 Bar
Testing authority	EN442
Maximum operating pressure	10 Bar
Maximum working temperature	110°C
Packaging	Corrugated cardboard, plastic reinforcing corner covers, polyethylene shrinking foil.

PLEASE NOTE: Systems using micro bore pipework must have adequate pressure and flow rates for the number and style of radiators on the system.

Guarantees & Liabilities

This product is guaranteed for 10 years. As we are not the manufacturers of this product we will take all reasonable endeavours to make over to you the benefit of any warranty or guarantee given by the manufacturer.

The guarantees in all cases are subject to the products being installed in accordance with British and or European standards as well as these fitting instructions. The guarantees in all cases are restricted to the free of charge replacement or repair of the failed product only. Our liability will under no circumstances extend beyond the repair or replacement of the product supplied by us. Claims for either labour in replacement or damage to property are not admissible. Any goods that are returned, in the event of a problem, will belong to us.

Terms & Conditions

All products must be inspected once removed from the packaging and your point of purchase notified within 28 days of delivery of any scratches, blemishes or other damage. Your point of purchase will then agree appropriate action. Imperfect radiators should therefore not be fitted and we will not accept responsibility for replacement of scratched or damaged radiators once they have been fitted. This includes any consequential loss or cost of fitting.

If we are not notified within 28 days of the date on the signed delivery note then it will be deemed that we have fully complied with our obligations and claims will not be considered.

Failure to comply with any of the above may invalidate any claims. We recommend that after you check the product on delivery that it is stored in its packaging to prevent damage prior to installation, we cannot accept responsibility for items damaged after delivery.

For full details of our Terms and Conditions please visit www.supplies4heat.co.uk or call us on 01342 306880.

www.supplies4heat.co.uk 01342 306880