

JIS EUROPE
100% STAINLESS STEEL

EST 1997

HEATED TOWEL RAILS

Steyring 1000mm x 300mm

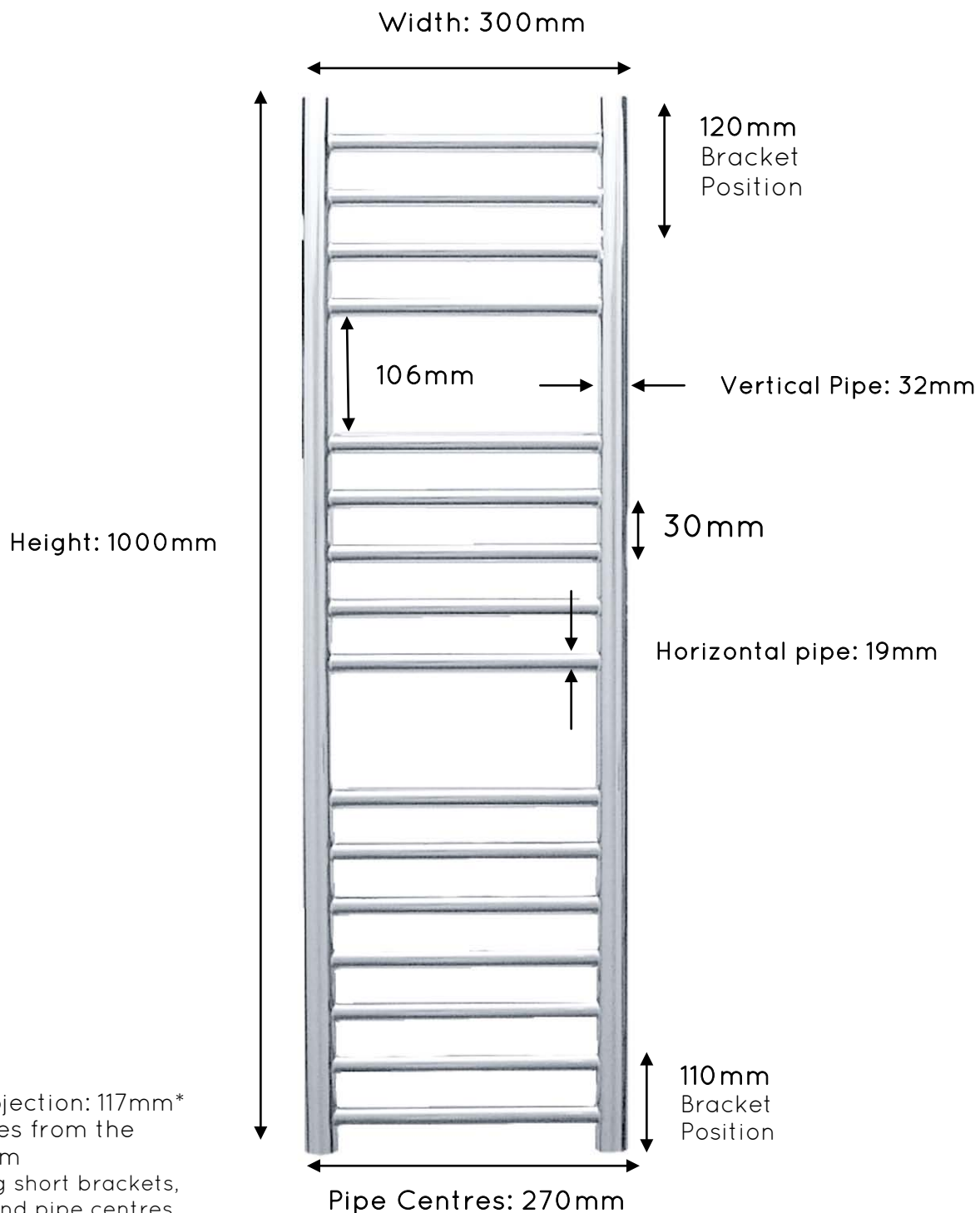

Overall Projection: 117mm*
Pipe Centres from the Wall: 102mm

*When using short brackets, projection and pipe centres from wall will be reduced by 25mm.

JIS EUROPE
100% STAINLESS STEEL

EST 1997

HEATED TOWEL RAILS

Steyrning 1000mm x 400mm

Width: 400mm

Height: 1000mm

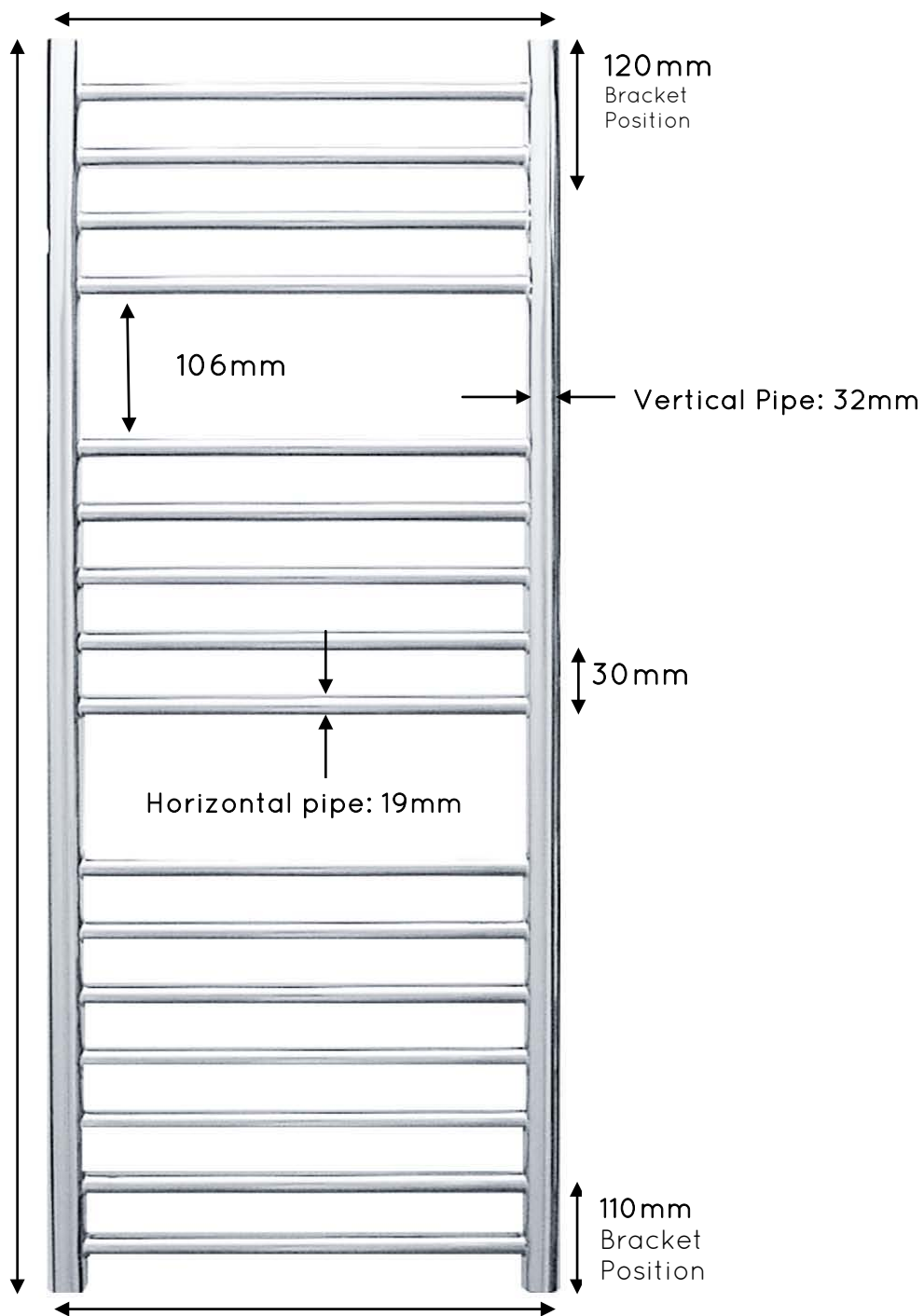

Overall Projection:
117mm*
Pipe Centres from
the Wall: 102mm
*When using short
brackets, projection
and pipe centres from
wall will be reduced by
25mm.

JIS EUROPE
100% STAINLESS STEEL

EST 1997

HEATED TOWEL RAILS

Steying 1000mm x 520mm

Width: 520mm

Height: 1000mm

120mm
Bracket
Position

106mm

Vertical Pipe: 32mm

30mm

Horizontal pipe: 19mm

110mm
Bracket
Position

Pipe Centres: 490mm

Overall Projection:
117mm*

Pipe Centres from the
Wall: 102mm

*When using short brackets,
projection and pipe centres
from wall will be reduced by
25mm.

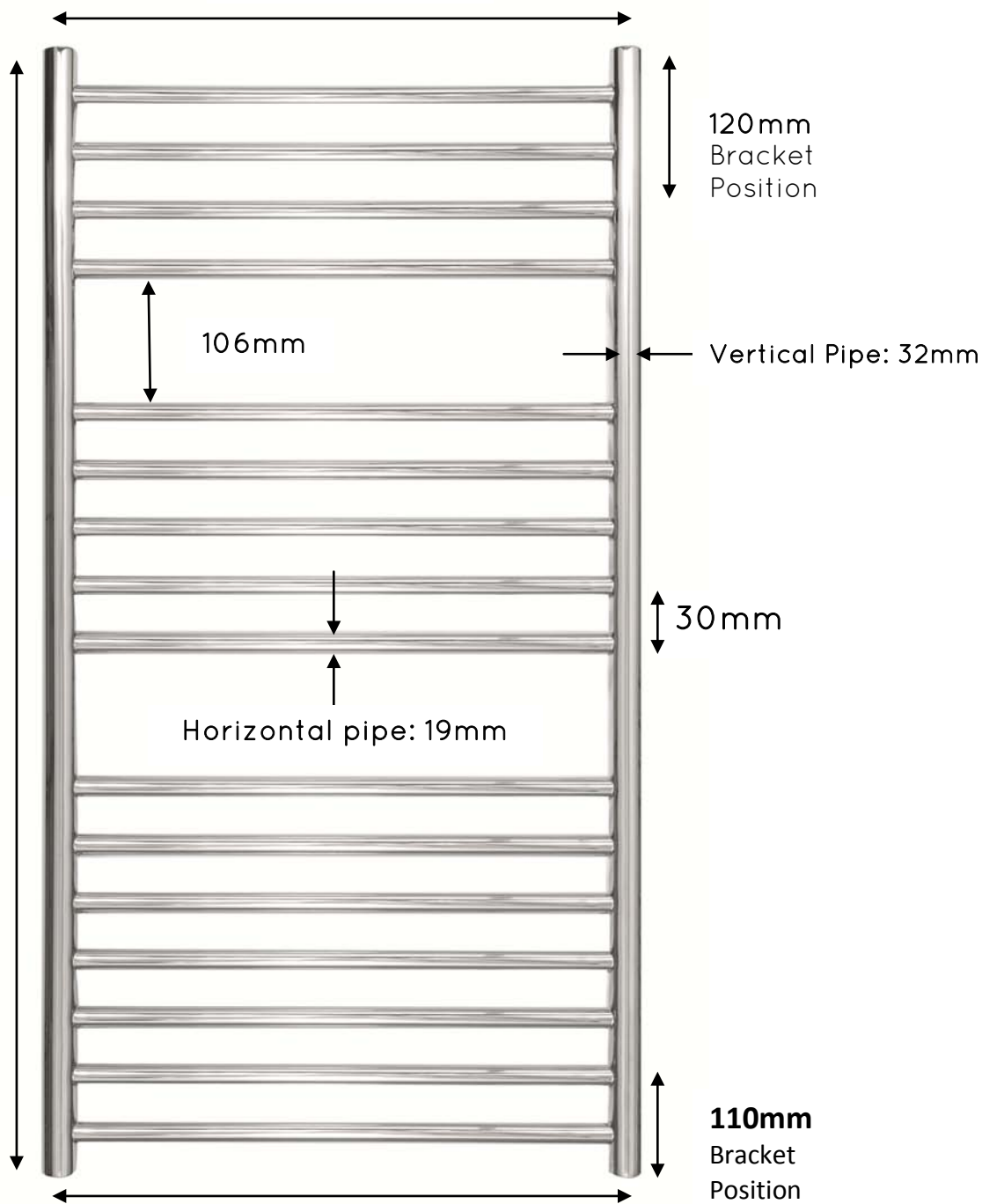

JIS EUROPE
100% STAINLESS STEEL

EST 1997

HEATED TOWEL RAILS

Steying 1000mm x 620mm

Width: 620mm

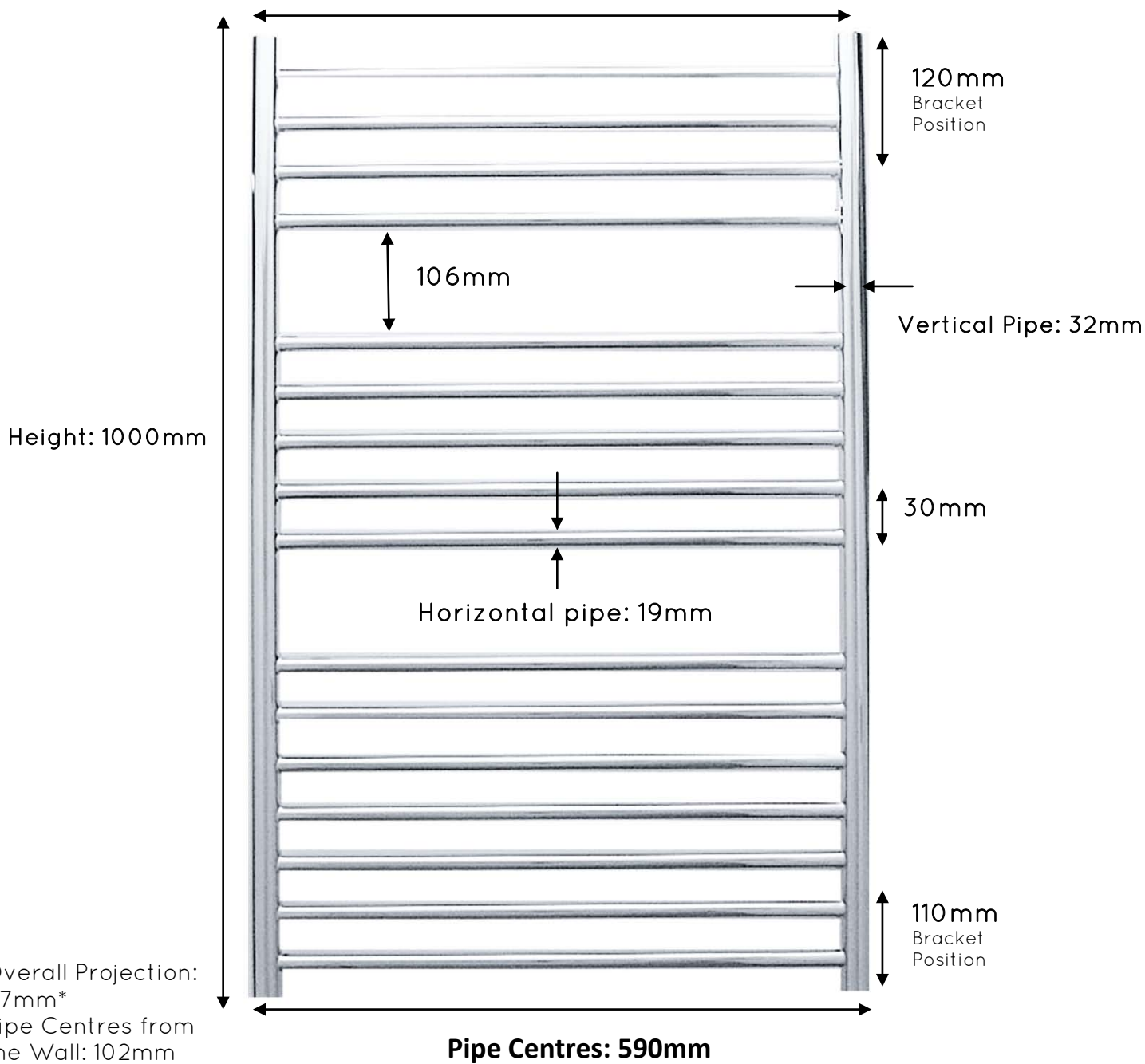

Overall Projection:
117mm*

Pipe Centres from
the Wall: 102mm

*When using short
brackets, projection
and pipe centres
from wall will be
reduced by 25mm.