

Pulsar



Dual Fuel options see pages 116-117

1224mm x 500mm in Platinum with Nickel Mini Cube valves

Pulsar

shown on page 100

High quality Italian design & manufacture.
Steel; frame style, elliptical cross tubes
UKCA approved & certified to BS EN442

White RAL 9016 as standard, 188 RAL Colours and 30 Special Finishes
Please call **01342 302250** for a RAL or Special Finish chart

Stock White RAL 9016: 48-72 Hours
Made to Order sizes & colours: Up to 5 weeks

Pipe centres left to right	Pipe centres from wall	Depth from wall
width - 44mm	71mm - 86mm	92mm - 107mm

Stock options White RAL 9016

Height (mm)	Width (mm)	Model	Watts Δt 50°C	Btu's Δt 50°C
1224	500	PULSI250	604	2061
	600	PULSI260	710	2423

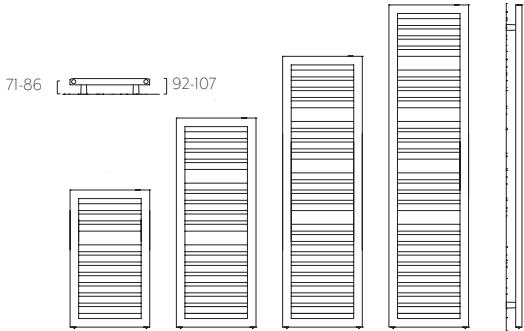

SAVE MONEY! WHEN YOU BUY OUR **CYLINDER KIT** WITH ANY TOWEL RAIL ORDER* QUOTE **PROMOV3** AT TIME OF ORDER

Available in White or Chrome

Made to order options - White & colours

Height (mm)	Width (mm)	Model	Watts Δt 50°C	Btu's Δt 50°C
804	450	PULS8045	374	1276
	500	PULS8050	409	1396
	600	PULS8060	479	1634
1224	450	PULSI245	551	1880
1584	450	PULSI545	684	2334
	500	PULSI550	753	2569
	600	PULSI560	892	3044
1884	450	PULSI845	825	2815
	500	PULSI850	903	3081
	600	PULSI860	1058	3610

*Saving based on the value of individual items when bought separately. Order any of our selected valves & matching pipe covers at the same time as your radiator; PROMOV3W (white), PROMOV3C (chrome).

Blues

shown on page 112

Stainless Steel; 15mm x 30mm horizontal tubes with 30mm x 30mm collectors
Suitable for a direct system
UKCA approved & certified to BS EN442

Polished or Satin Stainless Steel

Stock Polished Stainless Steel: 48-72 Hours
Made to Order Satin Stainless Steel: Up to 4 weeks

Pipe centres left to right	Pipe centres from wall	Depth from wall
50mm	55mm to 70mm	85mm to 100mm

Stock options Polished Stainless Steel

Height (mm)	Width (mm)	Model	Watts Δt 50°C	Btu's Δt 50°C
770	500	BLUE7750	236	805
1190	500	BLUE1150	337	1150
1400	500	BLUE1450	379	1293

Made to order options - Satin Stainless Steel

Height (mm)	Width (mm)	Model	Watts Δt 50°C	Btu's Δt 50°C
770	500	BLUE7750	236	805
1190	500	BLUE1150	337	1150
1400	500	BLUE1450	379	1293



SAVE MONEY! WHEN YOU BUY OUR **CYLINDER KIT** WITH ANY TOWEL RAIL ORDER* QUOTE **PROMOV3** AT TIME OF ORDER

Available in White or Chrome

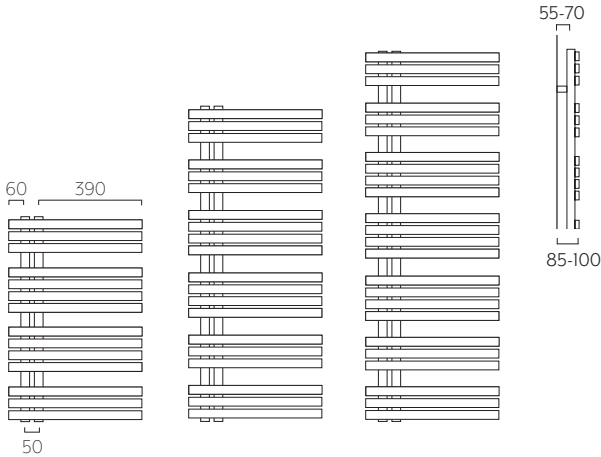

PULSAR TOWEL RAIL

Fitting Instructions

Accessories not included

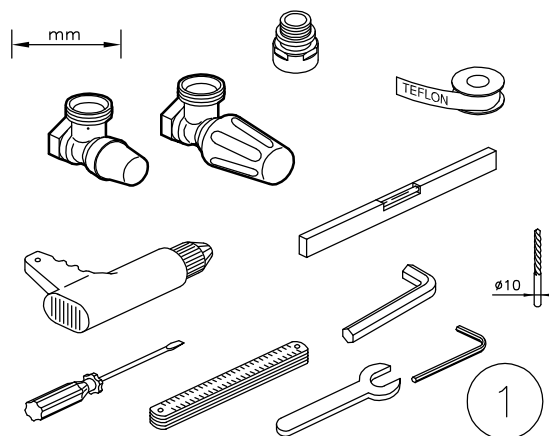

Accessories included

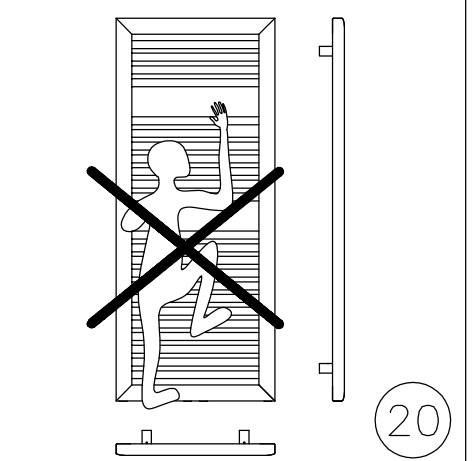
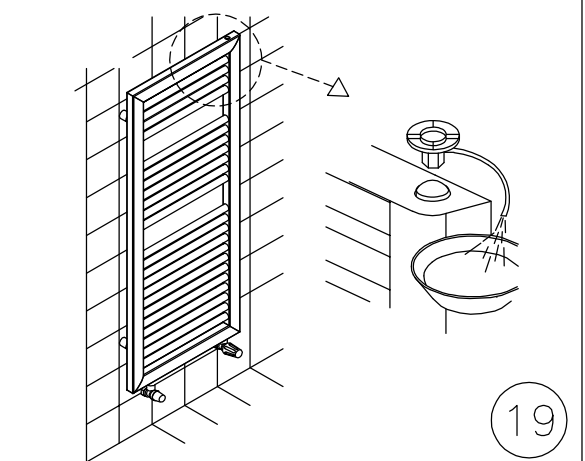
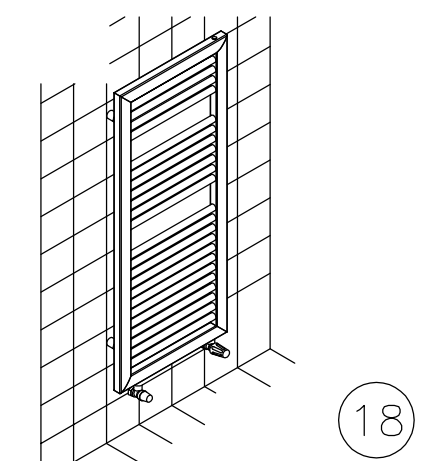
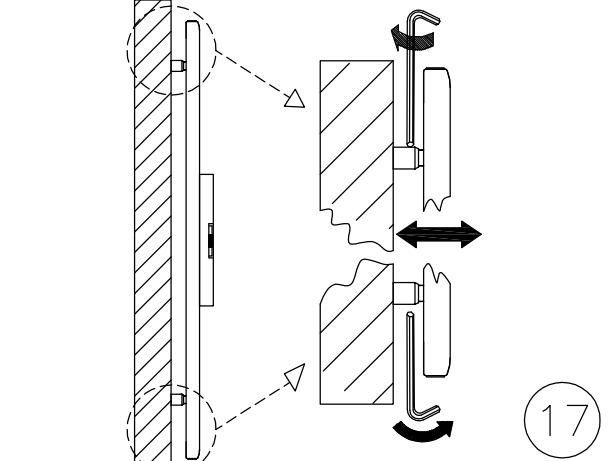
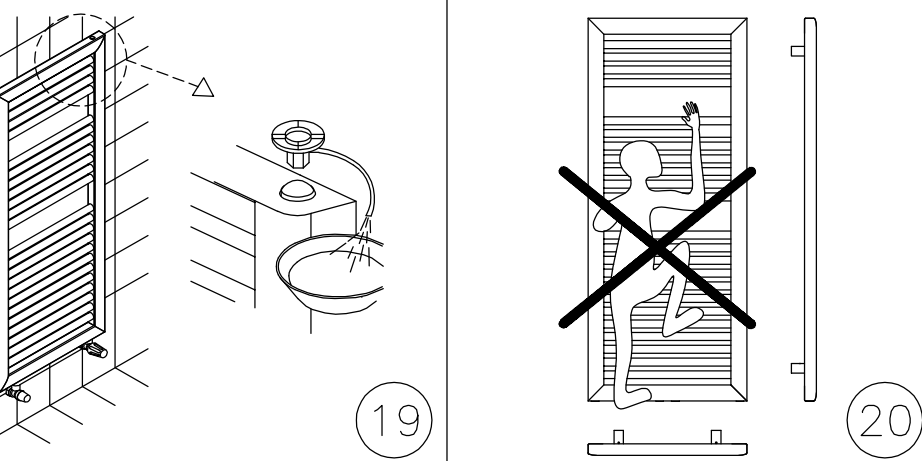
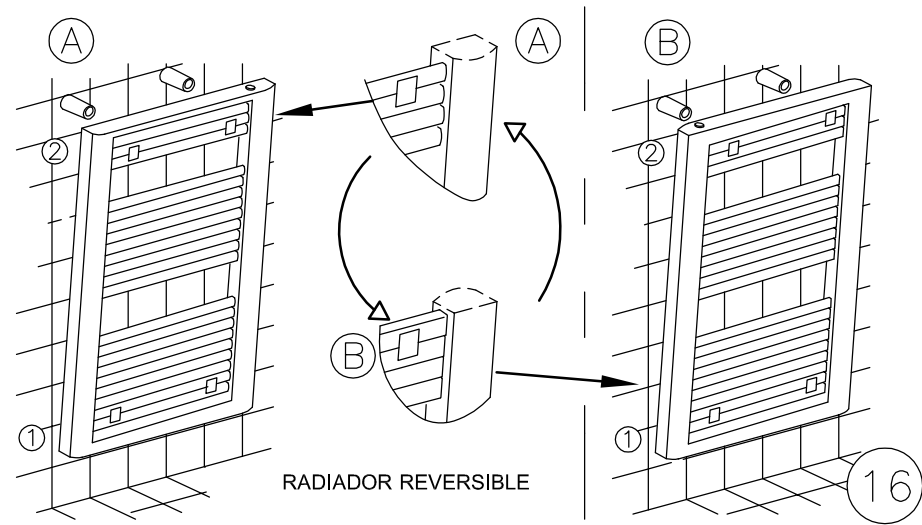
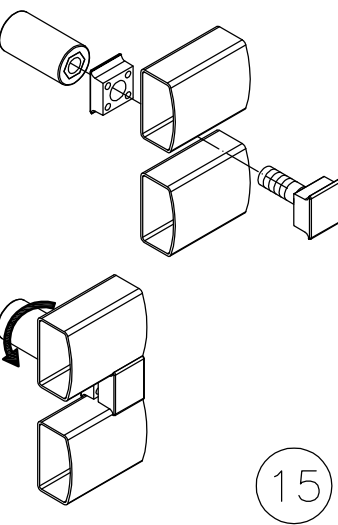
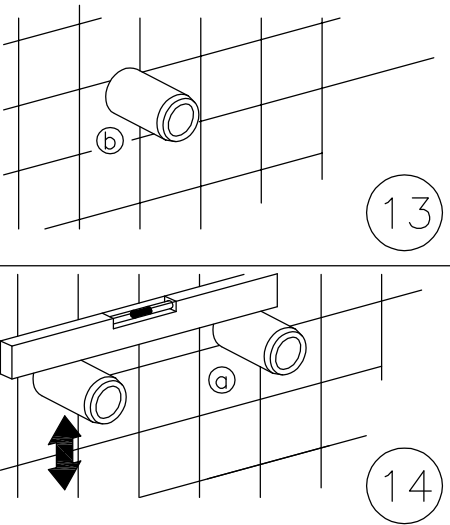
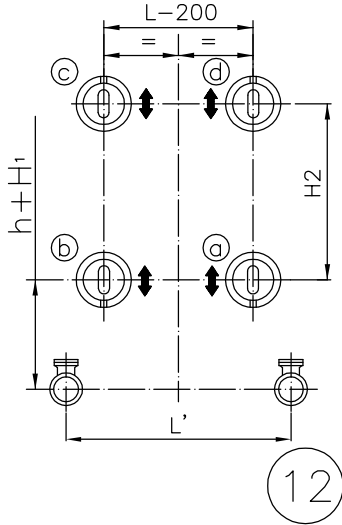
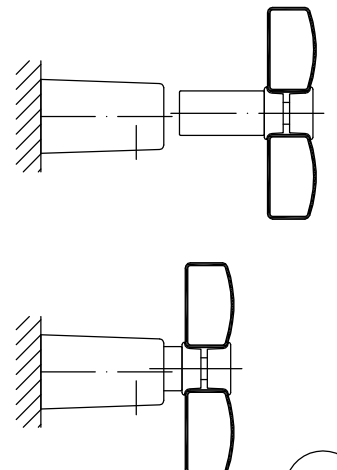
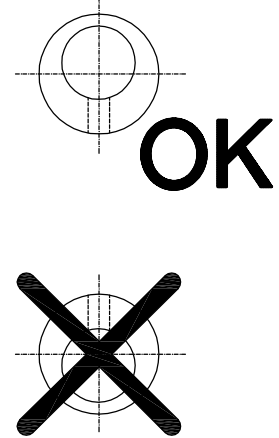
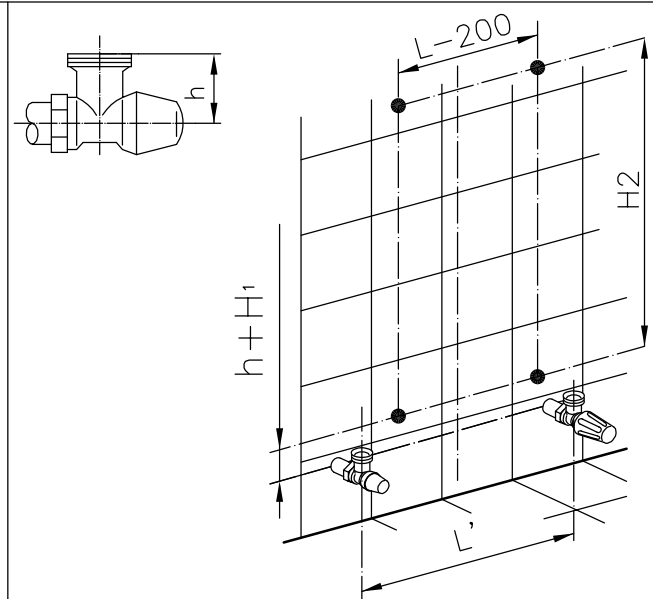
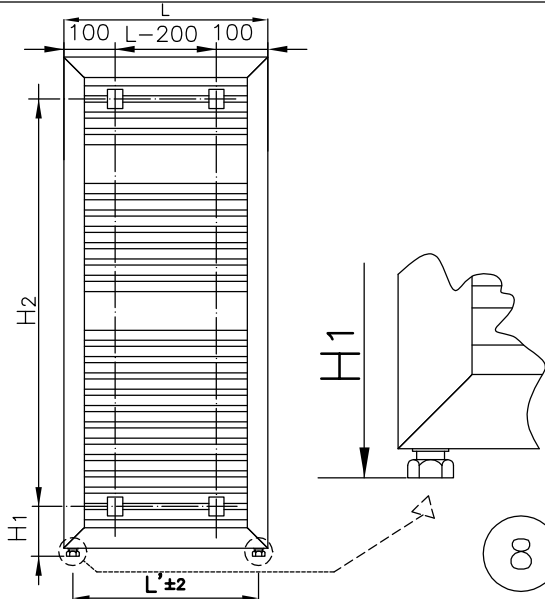
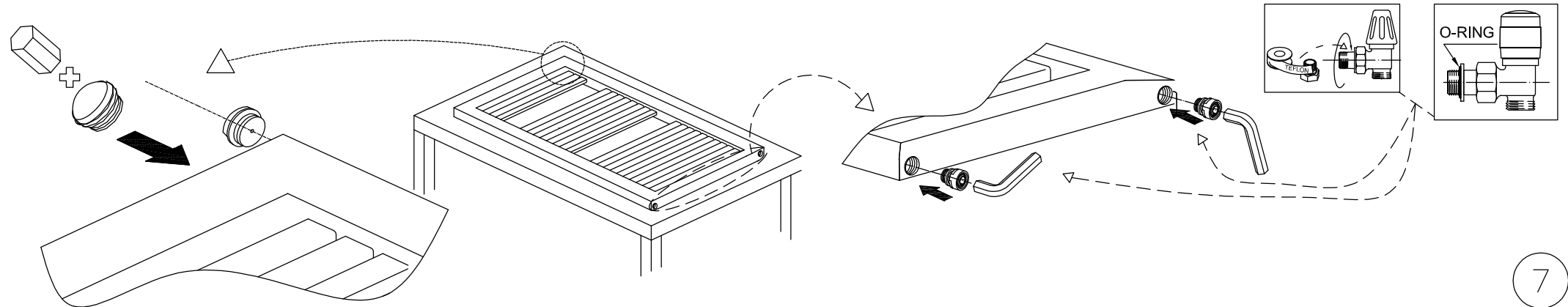
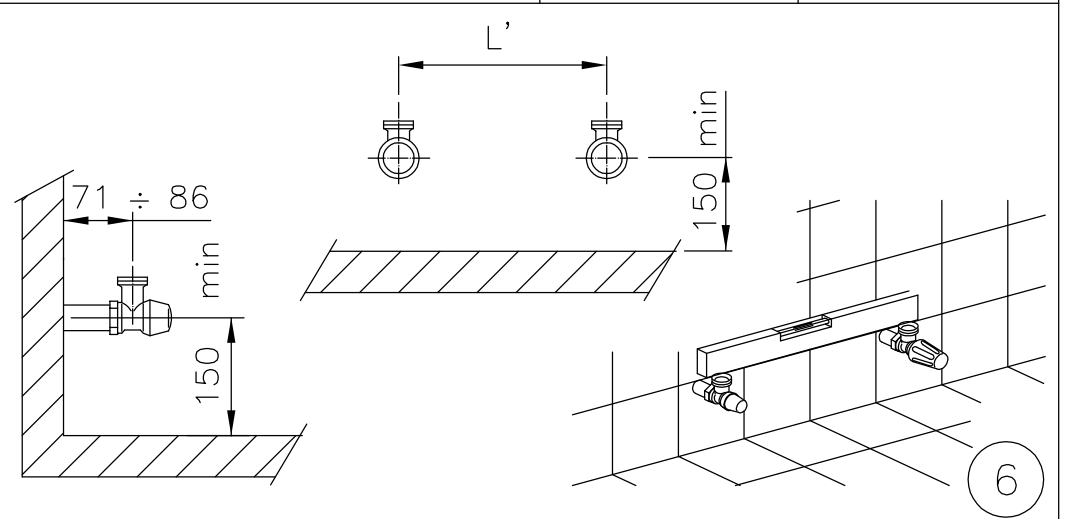
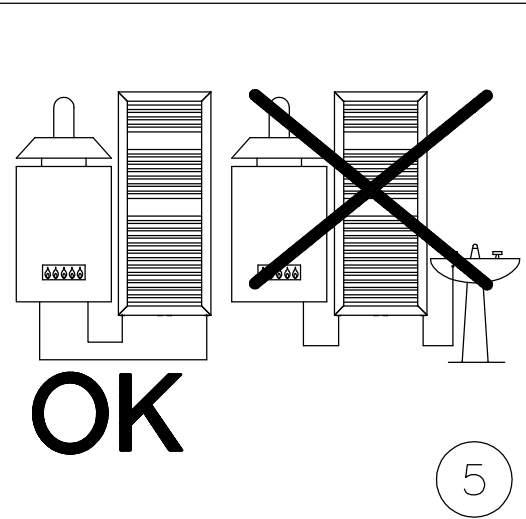
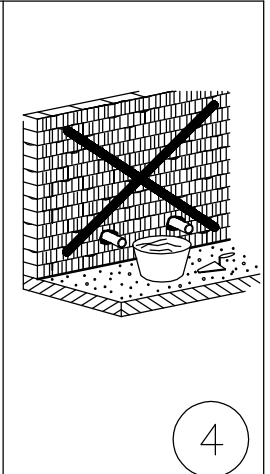
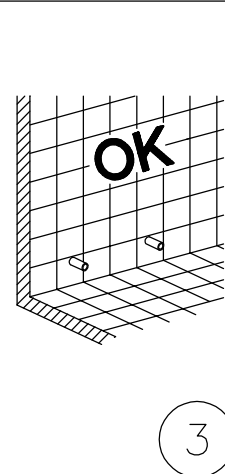
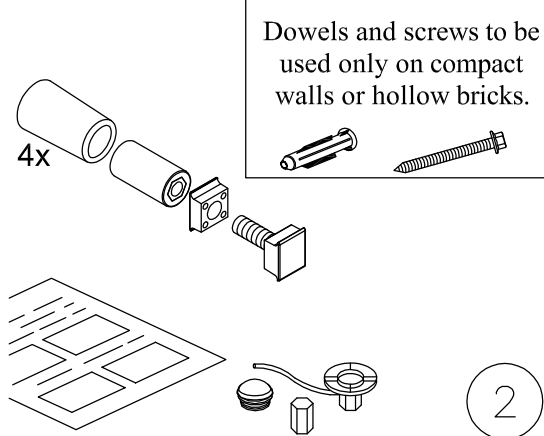

COMMISSION

Please Note: In accordance with Part L1 2006 of the Building Regulations and BS7593:1992 code of practice for the treatment of hot water and central heating systems, we strongly recommend flushing the heating system post installation of new radiators and then adding the correct quantity and type of inhibitor for use with your radiator and system to prevent corrosion. Damage caused to systems not protected by a suitable inhibitor will not be covered by manufacturer’s guarantee.

TECHNICAL SPECIFICATIONS

Materials	Mild Steel.
Connections	½ flow and return.
Test pressure	8 Bar
Testing authority	EN 442
Maximum operating pressure	6 Bar
Maximum working temperature	95°C
Packaging	Wrapped in polyethylene with cardboard box.
PLEASE NOTE: Systems using micro bore pipework must have adequate pressure and flow rates for the number and style of radiators on the system.	

TERMS & CONDITIONS

All products must be inspected once removed from the packaging and The Radiator Company notified within 28 days of delivery of any scratches, blemishes or other damage.

The Radiator Company will then replace the radiator.

Imperfect radiators should therefore not be fitted and The Radiator Company will not accept responsibility for replacement of scratched or damaged radiators once they have been fitted. This includes any consequential loss or cost of fitting.

If The Radiator Company are not notified within 28 days of the date on the signed delivery note then it will be deemed that The Radiator Company have fully complied with its obligations and claims will not be considered.

Failure to comply with any of the above may invalidate any claims.

We recommend that after you check the product on delivery that it is stored in its packaging to prevent damage prior to installation. The Radiator Company cannot accept responsibility for items damaged after delivery.

GUARANTEES & LIABILITIES

This product is guaranteed for 10 years . The guarantee is subject to the product being installed in accordance with British and or European standards as well as these fitting instructions. The guarantee in all cases are restricted to the free of charge replacement or repair of the failed product only. Our liability will under no circumstances extend beyond the repair or replacement of the product supplied by us. Claims for either labour in replacement or damage to property are not admissible. Any goods that are returned, in the event of a problem, will belong to The Radiator Company.

The Radiator Company
Units 13 - 14 Charlwoods Road
East Grinstead
West Sussex
RH19 2HU

A brand of **IRSAP** , Italy’s leading manufacturer of design led radiators.

If you have any questions please contact us on 01342 302250
www.theradiatorcompany.co.uk