

APOLLO ravenna plus TBJR technical specification

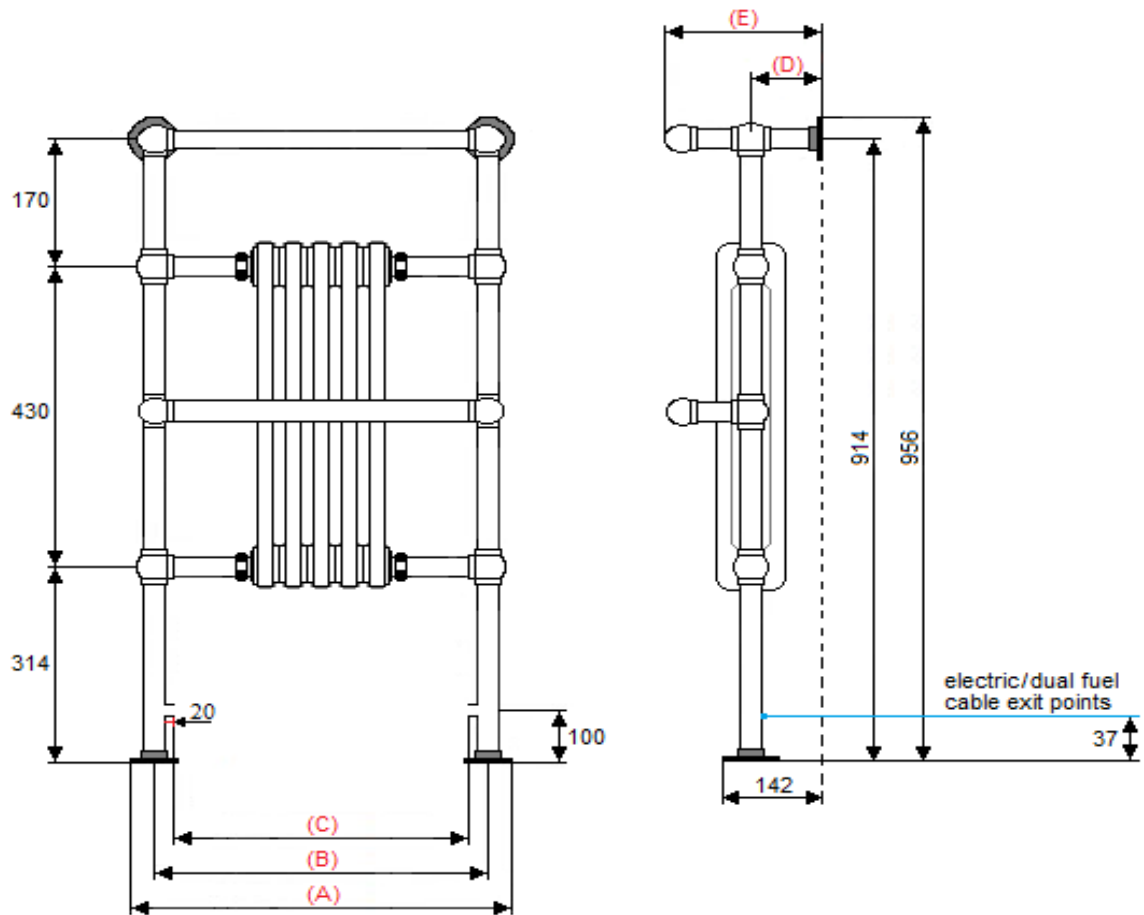

RAVENNA PLUS TBJR DIMENSIONS (mm)

		TBJR4		TBJR6	
Model code					
Width of radiator	(A)	509		694	
Model height			956		
Pipe centres	Width	(B)	425		610
	Depth	(D)		100	
Depth of rail	(E)		240		
No. of sections in insert			5		8
Tapping centres	Inward	(C)	353		538
Bracket positions			wall/floor plates		
Tappings			1/2"		

RAVENNA PLUS TBJR WEIGHTS AND VOLUMES (per radiator)

Model width (mm)	509	694
Dry weight (A) Kg	13.36	17.63
Water content (B) Litres	6.80	9.60
Working weight (A+B) Kg	20.16	27.23
Outputs: Watts $\Delta T=50k$	670	1025

The thermal outputs expressed at $\Delta T=50k$ comply with European regulation EN 442-2

ADDITIONAL INFORMATION

Material	Brass (DZR)
Alloy thickness	1 - 1.6mm
Tube diameter	31.8mm
Maximum working pressure	3 bar/300 kPa
Maximum working temperature	85°C
Maximum testing pressure	6 bar/600 kPa

DUAL FUEL/ELECTRIC INFORMATION (where applicable)

Position of cable exit point	Back of leg
Distance from floor to cable exit point	37mm
Element	300W

TEMPERATURE

FACTORS FOR DIFFERENCES BETWEEN MEAN WATER TEMPERATURE AND ROOM TEMPERATURE IN °C AND °F OTHER THAN 50°C (90°F)

5°C	0.050		
10°C	0.123	10°F	0.057
15°C	0.209	20°F	0.142
20°C	0.304	30°F	0.240
25°C	0.406	40°F	0.348
30°C	0.515	50°F	0.466
35°C	0.629	60°F	0.590
40°C	0.748	70°F	0.721
45°C	0.872	80°F	0.858
50°C	1.000	90°F	1.000
55°C	1.132	100°F	1.147
60°C	1.267	110°F	1.298
65°C	1.406	120°F	1.454
70°C	1.549	130°F	1.613
75°C	1.694	140°F	1.776

TO APPLY THE FACTORS SHOWN IN THE TABLE TO OUR QUOTED OUTPUTS MULTIPLY THE QUOTED OUTPUT BY THE CHOSEN OPERATING FACTOR TO GIVE THE OUTPUT

Please note: These towel rails are handmade and therefore subject to a tolerance of +/- 6mm on all measurements

This drawing: Is the property of Apollo Radiators Ltd and may not be reproduced or transmitted to third parties without authorisation

APOLLO ravenna plus TBJR4_15H technical specification

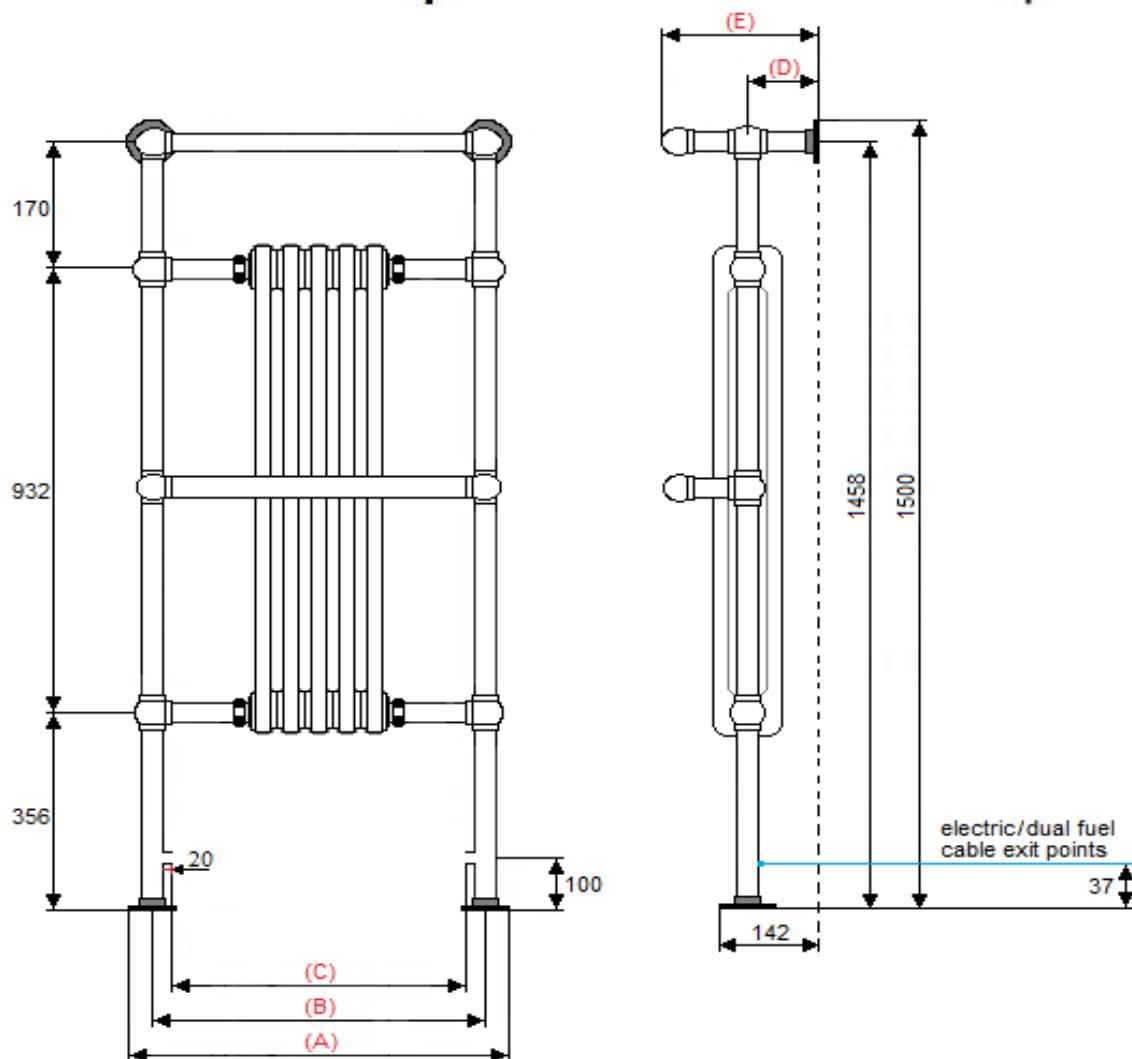

RAVENNA PLUS TBJR4_15H DIMENSIONS (mm)

RAVENNA PLUS TBJR4_15H DIMENSIONS (mm)			TBJR4_15H
Model code			TBJR4_15H
Width of radiator	(A)		509
Model height			1500
Pipe centres	Width	(B)	425
	Depth	(D)	100
Depth of rail		(E)	240
No. of sections in insert			5
Tapping centres	Inward	(C)	353
Bracket positions			wall/floor plates
Tappings			1/2"

TEMPERATURE FACTORS FOR DIFFERENCES BETWEEN MEAN WATER TEMPERATURE AND ROOM TEMPERATURE IN °C AND °F OTHER THAN 50°C (90°F)

5°C	0.050	10°F	0.057
10°C	0.123	20°F	0.142
15°C	0.209	30°F	0.240
20°C	0.304	40°F	0.348
25°C	0.406	50°F	0.466
30°C	0.515	60°F	0.590
35°C	0.629	70°F	0.721
40°C	0.748	80°F	0.858
45°C	0.872	90°F	1.000
50°C	1.000	100°F	1.147
55°C	1.132	110°F	1.298
60°C	1.267	120°F	1.454
65°C	1.406	130°F	1.613
70°C	1.549	140°F	1.776
75°C	1.694		

TO APPLY THE FACTORS SHOWN IN THE TABLE TO OUR QUOTED OUTPUTS MULTIPLY THE QUOTED OUTPUT BY THE CHOSEN OPERATING FACTOR TO GIVE THE OUTPUT

RAVENNA PLUS TCR4_15H WEIGHTS AND VOLUMES (per radiator)

Model width (mm)		509
Dry weight (A) Kg		20.73
Water content (B) Litres		11.71
Working weight (A+B) Kg		32.44
Outputs: Watts ΔT=50k		1120

The thermal outputs expressed at ΔT=50k comply with European regulation EN 442-2

ADDITIONAL INFORMATION

Material	Brass (DZR)
Alloy thickness	1 - 1.6mm
Tube diameter	31.8mm
Maximum working pressure	3 bar/300 kPa
Maximum working temperature	85°C
Maximum testing pressure	6 bar/600 kPa

DUAL FUEL/ELECTRIC INFORMATION (where applicable)

Position of cable exit point	Back of leg
Distance from floor to cable exit point	37mm
Element	400W

Please note: These towel rails are handmade and therefore subject to a tolerance of +/- 6mm on all measurements

This drawing: Is the property of Apollo Radiators Ltd and may not be reproduced or transmitted to third parties without authorisation