

Step



Step Electric in Chrome



Step 1240mm x 500mm shown in Chrome

Step shown on page 91

High quality Italian design & manufacture
Aluminium; vertical ladder rail. Hydronic & Electric models
10 year guarantee, UKCA approved & certified to BS EN442



SAVE MONEY! WHEN YOU BUY OUR **CYLINDER KIT** WITH ANY TOWEL RAIL ORDER*
QUOTE **PROMOV3** AT TIME OF ORDER

Available in White or Chrome

White Pearl & Chrome

Made to Order:
Up to 5 weeks: White Pearl & Chrome
Up to 5 weeks for White Pearl electric, 7 weeks for Chrome

Pipe centres left to right	Pipe centres from wall	Depth from wall
width - 224mm	60mm - 67mm	107mm - 114mm

Made to order options - White Pearl



Height (mm)	Width (mm)	Model	Watts $\Delta t 50^{\circ}c$	Btu's $\Delta t 50^{\circ}c$
760	500	STEP7650WP	370	1262
	600	STEP7660WP	421	1436
1240	500	STEP1250WP	598	2040
	600	STEP1260WP	653	2228
1720	500	STEP1750WP	816	2784
	600	STEP1760WP	935	3190

107-114 [60-67

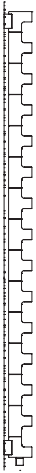
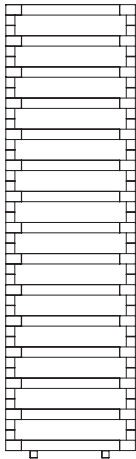
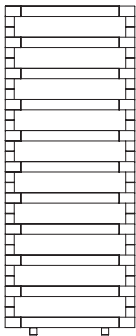
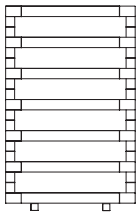

Made to order options - Chrome



Height (mm)	Width (mm)	Model	Watts $\Delta t 50^{\circ}c$	Btu's $\Delta t 50^{\circ}c$
760	500	STEP7650	273	931
	600	STEP7660	304	1037
1240	500	STEP1250	404	1378
	600	STEP1260	472	1610
1720	500	STEP1750	577	1969
	600	STEP1760	653	2228

Made to order options - Electric

Height (mm)	Width (mm)	Model	Watts $\Delta t 50^{\circ}c$
775	500	STEP7750E	250
1255	500	STEP1250E	450
1735	500	STEP1750E	650

The Step Electric has a number of functions that gives you complete control. You can set a desired temperature in adjustments from 7°C to 31°C, there is a boost facility delivers maximum power for 2 hours. It also has infra red capabilities for weekly programming, comfort and night time modes, via remote control.



*Saving based on the value of individual items when bought separately. Order any of our selected valves & matching pipe covers at the same time as your radiator; PROMOV3W (white), PROMOV3C (chrome).

STEP

Fitting Instructions

Accessories not included

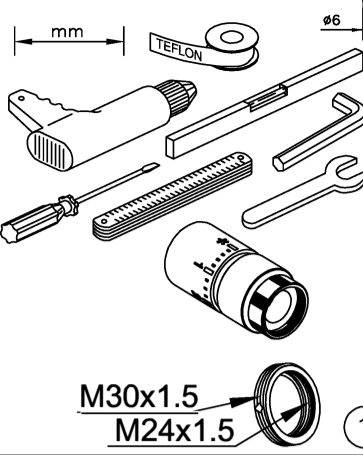

Accessories included

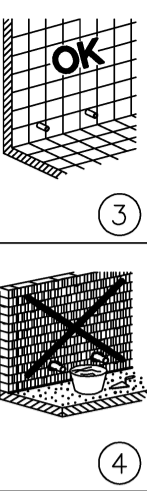
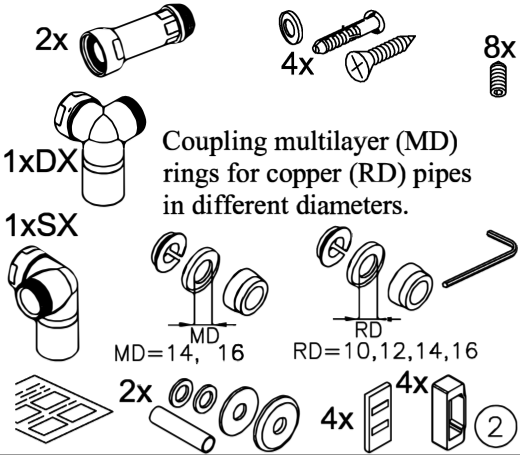

OK

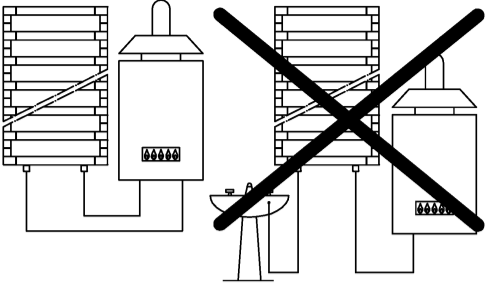

5

E	H mm	L mm	L' mm	X mm	Y mm	Z mm
7	760	500	277	685	475	17.5±4
		600	377	685	575	
11	1240	500	277	1165	475	
		600	377	1165	575	
15	1720	500	277	1645	475	
		600	377	1645	575	

6

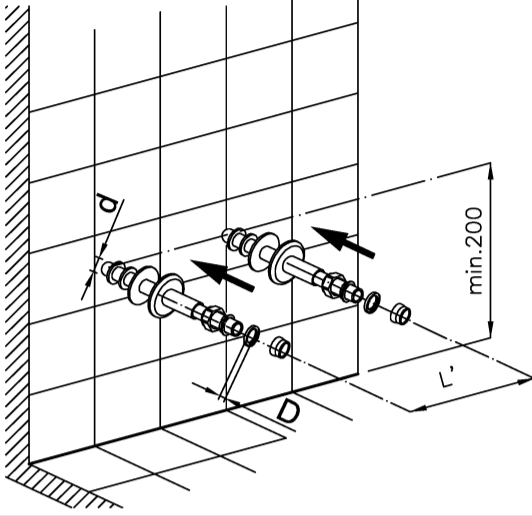

7

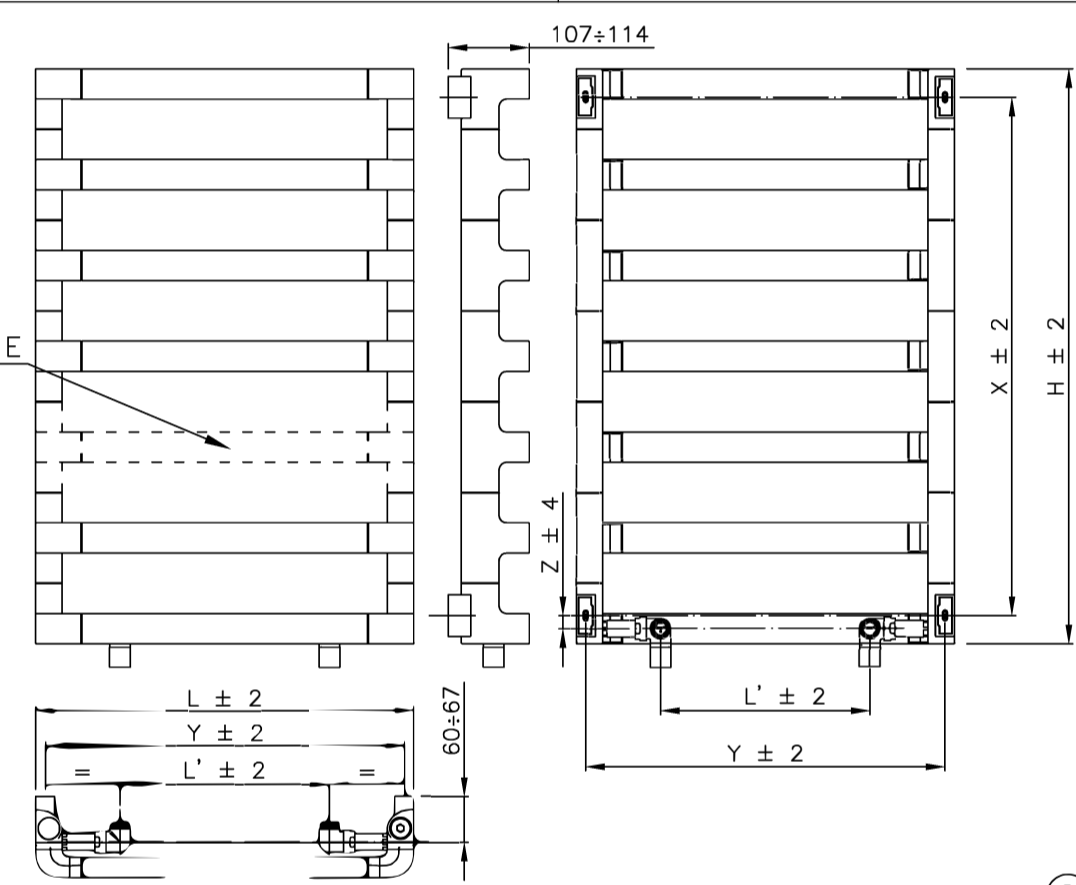

8

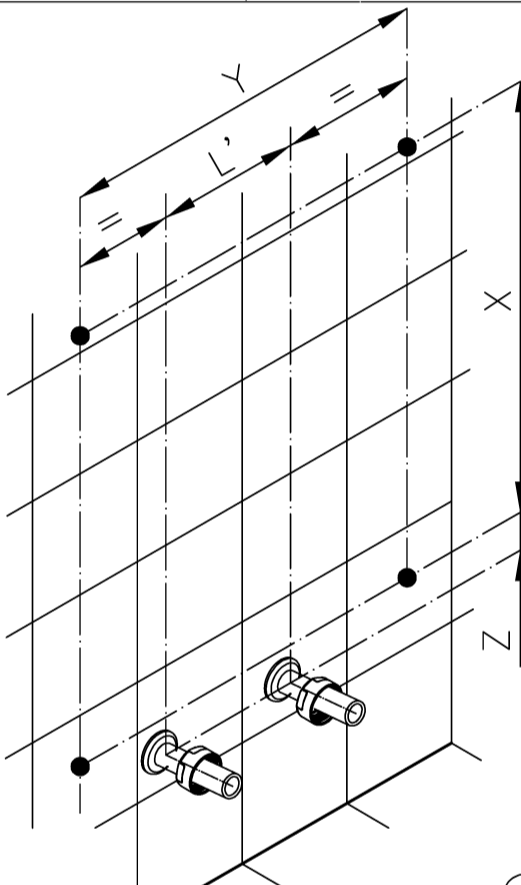

9

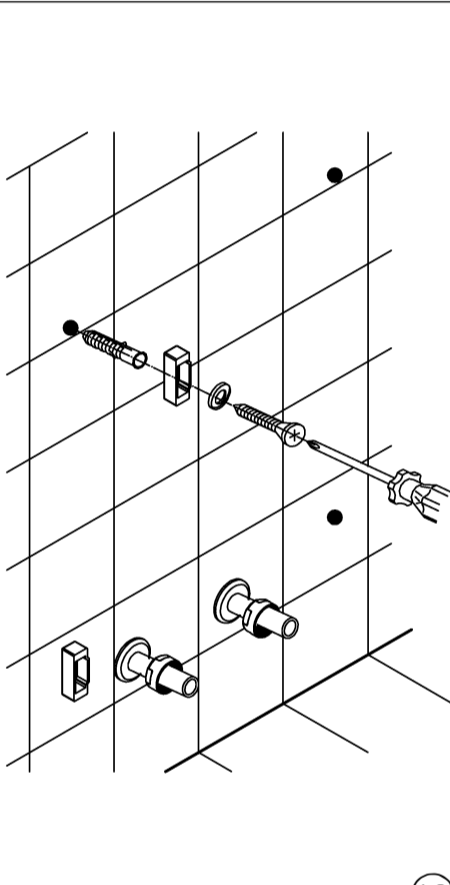

10

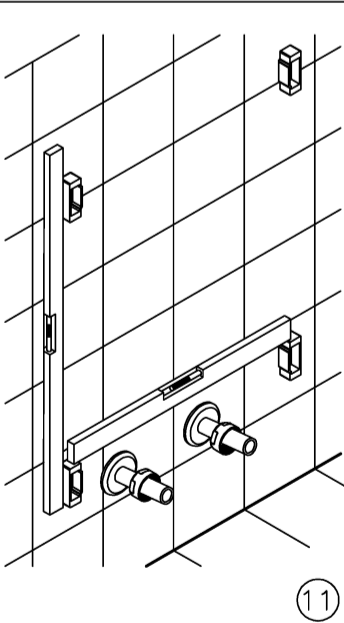

11

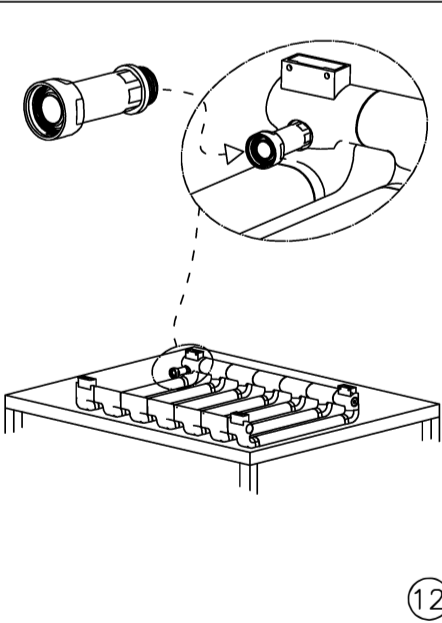

12

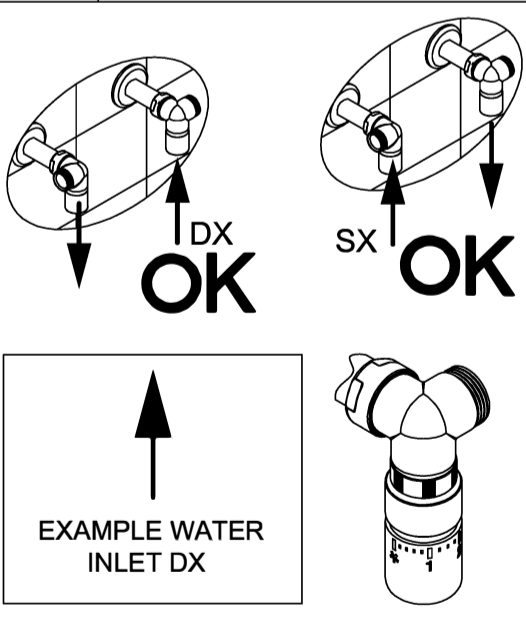
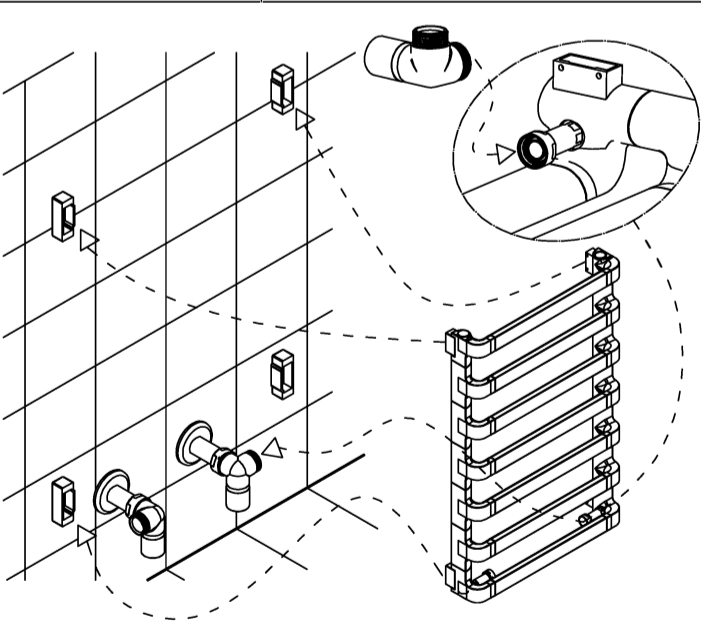

13

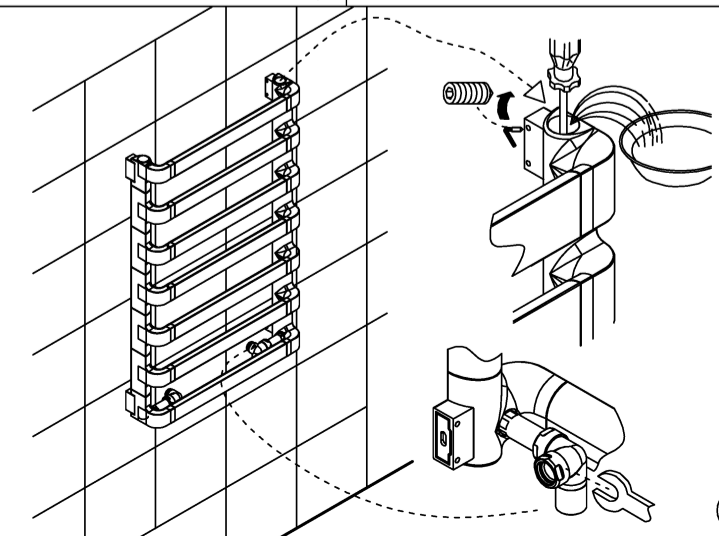

14

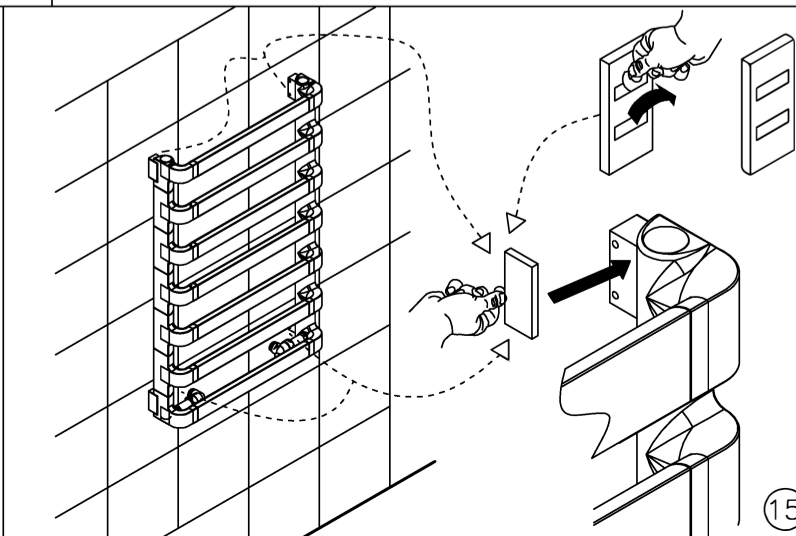

15

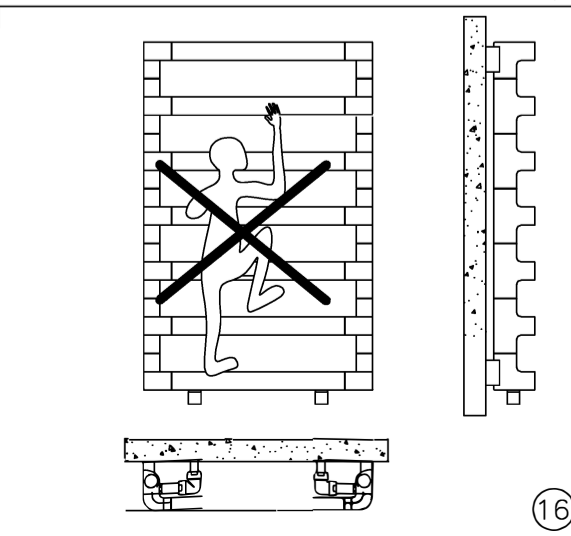

16

COMMISSION

Please Note: In accordance with Part L1 2006 of the Building Regulations and BS7593:1992 code of practice for the treatment of hot water and central heating systems, we strongly recommend flushing the heating system post installation of new radiators and then adding the correct quantity and type of inhibitor for use with your radiator and system to prevent corrosion. Damage caused to systems not protected by a suitable inhibitor will not be covered by manufacturer’s guarantee.

TECHNICAL SPECIFICATIONS

Materials	Mild Steel.
Connections	½ flow and return.
Test pressure	6 Bar
Testing authority	EN 442
Maximum operating pressure	4 Bar
Maximum working temperature	95°C
Packaging	Wrapped in polyethylene with cardboard box.
PLEASE NOTE: Systems using micro bore pipework must have adequate pressure and flow rates for the number and style of radiators on the system.	

TERMS & CONDITIONS

All products must be inspected once removed from the packaging and The Radiator Company notified within 28 days of delivery of any scratches, blemishes or other damage.

The Radiator Company will then replace the radiator.

Imperfect radiators should therefore not be fitted and The Radiator Company will not accept responsibility for replacement of scratched or damaged radiators once they have been fitted. This includes any consequential loss or cost of fitting.

If The Radiator Company are not notified within 28 days of the date on the signed delivery note then it will be deemed that The Radiator Company have fully complied with its obligations and claims will not be considered.

Failure to comply with any of the above may invalidate any claims.

We recommend that after you check the product on delivery that it is stored in its packaging to prevent damage prior to installation. The Radiator Company cannot accept responsibility for items damaged after delivery.

GUARANTEES & LIABILITIES

This product is guaranteed for 10 years . The guarantee is subject to the product being installed in accordance with British and or European standards as well as these fitting instructions. The guarantee in all cases are restricted to the free of charge replacement or repair of the failed product only. Our liability will under no circumstances extend beyond the repair or replacement of the product supplied by us. Claims for either labour in replacement or damage to property are not admissible. Any goods that are returned, in the event of a problem, will belong to The Radiator Company.

The Radiator Company
Units 13 - 14 Charlwoods Road
East Grinstead
West Sussex
RH19 2HU

A brand of **IRSAP** , Italy’s leading manufacturer of design led radiators.

If you have any questions please contact us on 01342 302250
www.theradiatorcompany.co.uk