

KARE L

INS-VS1

ALL MEASUREMENTS ARE IN MILLIMETRES

MANUFACTURED FROM STAINLESS STEEL

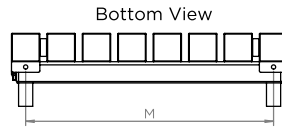
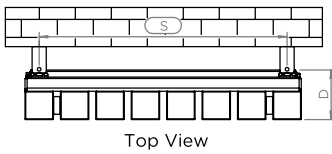
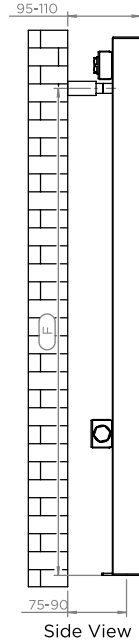
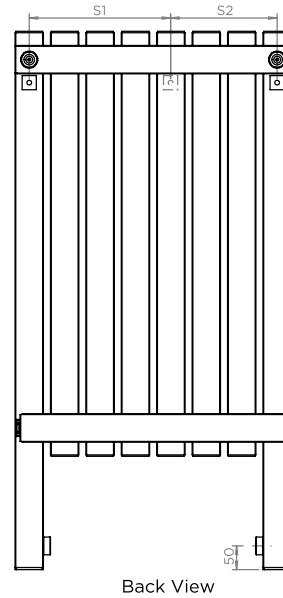
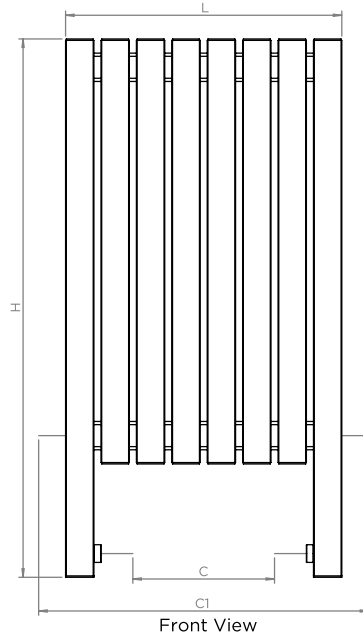
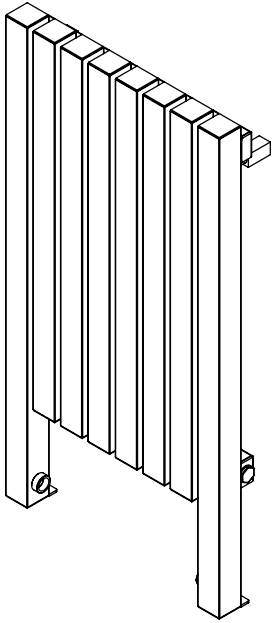

Installation Accessories:

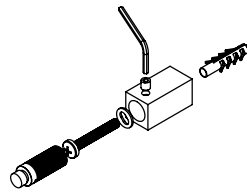
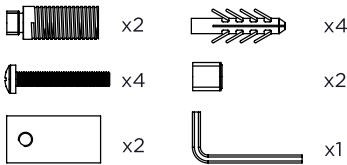

Plumbing Position:

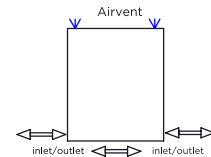

Vertical mount
 All Dimensions are in mm
 Max. Working Pressure: 10 Bar
 Max. Working Temperature: 95° C
 Inlet / Outlet : 1/2" BSP
 Fuel : E/H/D

Note: Dimension (S1,S2) available for minimum 24 profiles Manufacturing Tolerance : - 5 mm

PRODUCT CODE	Height	Length	Depth	Pipe Centres	Bracket Centres		
	H	L	D	C-Cl	F	S	M
	mm	mm	mm	mm	mm	mm	mm
KRL8-7660	760	390	70	200-466	688	350	350
KRL10-7660	760	490	70	300-566	688	450	450
KRL12-7660	760	590	70	400-666	688	550	550
KRL14-7660	760	690	70	500-766	688	650	650
KRL16-7660	760	790	70	600-866	688	750	750
KRL20-7660	760	990	70	800-1066	688	950	950
KRL24-7660	760	1190	70	1000-1266	688	600-550	1150
KRL28-7660	760	1390	70	1200-1466	688	700-650	1350
KRL32-7660	760	1590	70	1400-1666	688	800-750	1550
KRL36-7660	760	1790	70	1600-1866	688	900-850	1750

FR,71-Rev,00

Technical specifications are subject to change without prior notice.



AEON is the designer heating division of Pitacs Limited.
 Pitacs Limited, Bradbourne Point, Bradbourne Drive, Tilbrook, Milton Keynes,
 Buckinghamshire, MK7 8AT, UK

T: +44 (0)1908 271155 E: info@pitacs.com W: www.aeon.uk.com