



ELEN 18

POLISHED STAINLESS STEEL

WARRANTY
10 YEARS

MATERIAL:

- Vertical collectors in polished stainless steel \varnothing 30 mm.
- Horizontal elements in polished stainless steel \varnothing 18 mm.

FIXING KIT:

Brackets, airvent, hexagonal tool, plugs and screws for mounting suitable for use on compact or hollow brick, user notice.

The kit is certified from TÜV in compliance with VDI 6036 - class 4.

PACKAGING:

Carton angular and profiles protected by a recyclable film in polyethylene. User notice included.

FEATURES:

It is totally made in stainless steel with an unalterable finishing guaranteed during the years.

ACCESSORIES:

For the complete list, please refer to the accessories chapter.

AVAILABLE FUNCTIONS:

- Hot water
- Electric
- Dual energy

P. Max: 8 bar

Functioning: hot water

T. Max: 110° C

Connections: n° 2 x 1/2" G - 1 x 1/2" G

CERTIFICATES



ACCESSORIES



Kristal valve square with thermostatic option chromed

Copper conn. \varnothing 12/14/15
Art. nr. 5991990311165

Multilayer conn. \varnothing 16
Art. nr. 5991990311166



Kit 2 hooks polished stainless steel

Art. nr. 5991990010216



Towel bar polished stainless steel

width 350 mm

Art. nr. 5991990010221

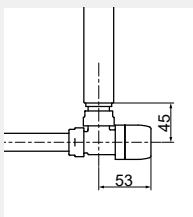

Quotes for square Kristal valves with thermostatic option

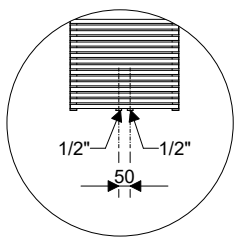

Detail of the pipe centres 50 mm version

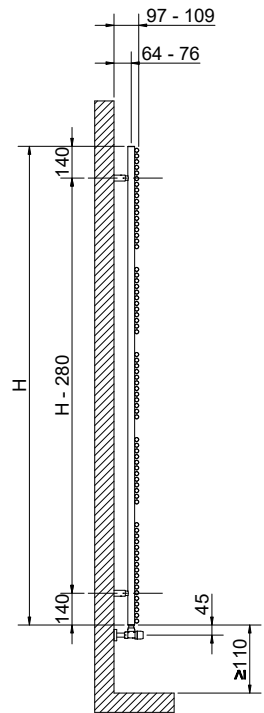
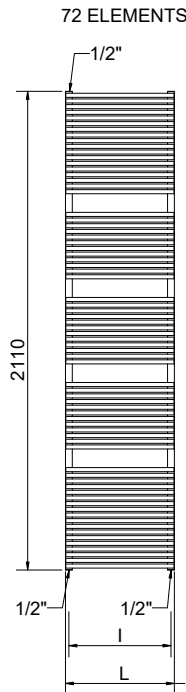
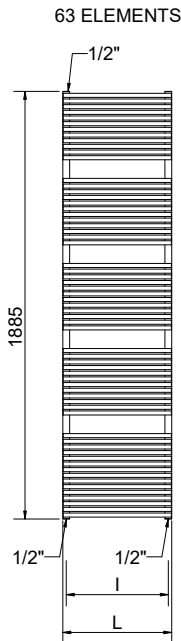
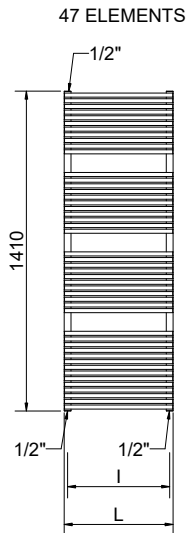
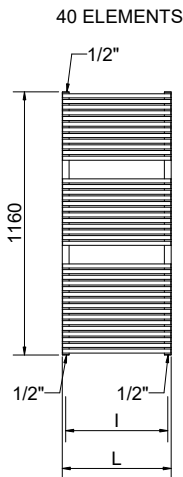
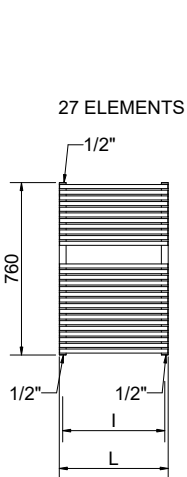
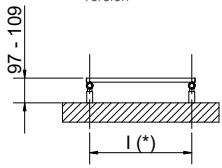

(*) The fixing kit has the same pipe centre (l) as the radiator

Quotes for Kristal valves

ELEN 18 POLISHED STAINLESS STEEL

Height [mm]	Width L [mm]	Pipe centres l [mm]	Art. nr.	Pipe centres 50 mm		Thermal output [Watt]			Dual energy kit [Watt]		
				Art. nr.	Dry Weight [Kg]	Surface [m ²]	Water content [lt]	Δt=50°C		Δt=30°C	Exp. n
760	430	400	3551440133130	3551440133147	7,8	0,8	3,5	282	147	1,2718	300
	480	450	3551440133134	3551440133151	9,2	0,9	4,0	358	188	1,2626	300
	430	400	3551440133131	3551440133148	11,5	1,2	5,3	415	217	1,2705	400
1160	480	450	3551440133135	3551440133152	13,7	1,4	6,0	523	275	1,2576	500
	530	500	3551440133138	3551440133155	15,7	1,6	6,8	631	333	1,2490	600
	580	550	3551440133142	3551440133159	19,8	2,1	8,3	846	449	1,2384	700
1410	430	400	3551440133132	3551440133149	13,7	1,4	6,3	486	254	1,2697	500
	480	450	3551440133136	3551440133153	16,2	1,7	7,2	609	321	1,2549	600
	530	500	3551440133139	3551440133156	18,6	1,9	8,1	732	388	1,2450	700
1885	580	550	3551440133143	3551440133160	23,3	2,4	9,9	978	521	1,2325	1000
	430	400	3551440133133	3551440133150	18,3	1,9	8,4	646	338	1,2681	600
	480	450	3551440133137	3551440133154	21,7	2,2	9,6	799	422	1,2487	700
2110	530	500	3551440133140	3551440133157	24,9	2,6	10,8	952	506	1,2357	900
	580	550	3551440133144	3551440133161	31,2	3,3	13,2	1259	675	1,2192	1200
	530	500	3551440133141	3551440133158	24,6	2,5	10,9	902	477	1,2453	900
730	580	550	3551440133145	3551440133162	28,3	2,9	12,3	1070	571	1,2305	1000
	730	700	3551440133146	3551440133163	35,6	3,8	15,0	1404	756	1,2117	1200

For output at different ΔT, please refer to the following formula: desired output = output at ΔT 50 x (desired Δt/50)ⁿ



ELEN 18

SATIN STAINLESS STEEL

WARRANTY
10 YEARS

MATERIAL:

- Vertical collectors in satin stainless steel \varnothing 30 mm.
- Horizontal elements in satin stainless steel \varnothing 18 mm.

FIXING KIT:

Brackets, airvent, hexagonal tool, plugs and screws for mounting suitable for use on compact or hollow brick, user notice.

The kit is certified from TÜV in compliance with VDI 6036 - class 4.

PACKAGING:

Carton angular and profiles protected by a recyclable film in polyethylene. User notice included.

FEATURES:

It is totally made in stainless steel with an unalterable finishing guaranteed during the years.

ACCESSORIES:

For the complete list, please refer to the accessories chapter.

AVAILABLE FUNCTIONS:

- Hot water
- Dual energy

P. Max: 8 bar

Functioning: hot water

T. Max: 110° C

Connections: n° 2 x 1/2" G - 1 x 1/2" G

CERTIFICATES



ACCESSORIES

Kristal valve square with thermostatic option satin



Copper conn. \varnothing 12/14/15
Art. nr. 5991990321143

Multilayer conn. \varnothing 16
Art. nr. 5991990321144

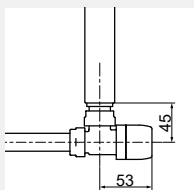

Quotes for square Kristal valves with thermostatic option

Kristal corner valve with thermostatic option satin



Copper conn. \varnothing 12/14/15
Art. nr. 5991990321136

Multilayer conn. \varnothing 16
Art. nr. 5991990321135

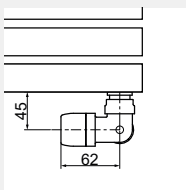

Quotes for corner Kristal valves with thermostatic option

Towel bar SATIN STAINLESS STEEL



width 350 mm

Available with width \geq 500 mm

Art. nr. 5991990010222

Kit 2 hooks SATIN STAINLESS STEEL



Art. nr. 5991990010217

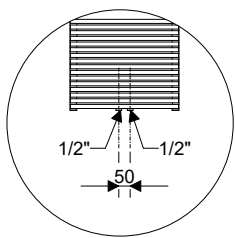

Detail of the pipe centres 50 mm version

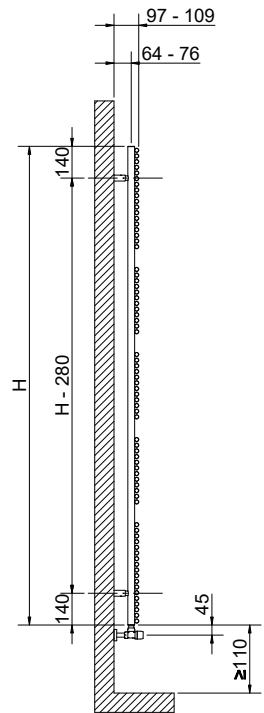
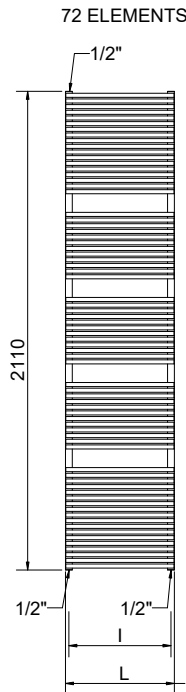
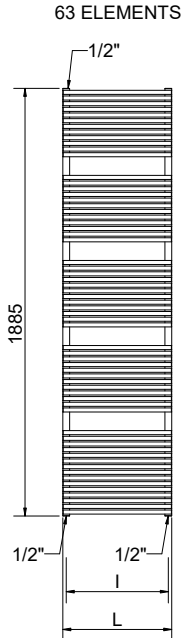
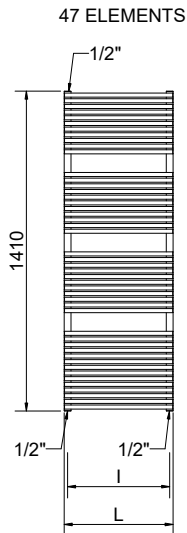
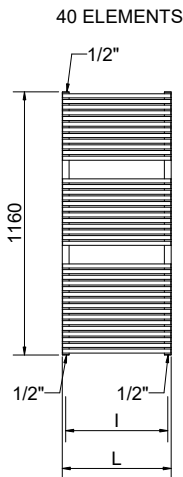
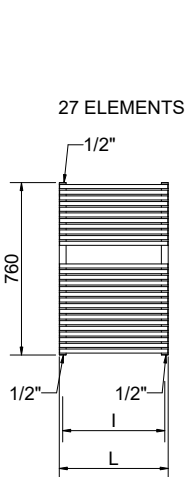
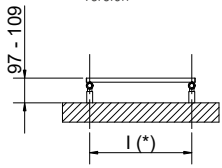

(*) The fixing kit has the same pipe centre (l) as the radiator

Quotes for Kristal valves

ELEN 18 SATIN STAINLESS STEEL

Height [mm]	Width L [mm]	Pipe centres l [mm]	Art. nr.	Pipe centres 50 mm		Thermal output [Watt]			Dual energy kit [Watt]		
				Art. nr.	Dry Weight [Kg]	Surface [m ²]	Water content [lt]	Δt=50°C		Δt=30°C	Exp. n
760	430	400	3551590133040	3551590133057	7,8	0,8	3,5	291	151	1,2856	300
	480	450	3551590133044	3551590133061	9,2	0,9	4,0	370	193	1,2714	300
	430	400	3551590133041	3551590133058	11,5	1,2	5,3	434	226	1,2795	400
1160	480	450	3551590133045	3551590133062	13,7	1,4	6,0	545	286	1,2634	500
	530	500	3551590133048	3551590133065	15,7	1,6	6,8	657	346	1,2527	600
	580	550	3551590133052	3551590133069	19,8	2,1	8,3	880	467	1,2395	900
1410	430	400	3551590133042	3551590133059	13,7	1,4	6,3	509	265	1,2762	500
	480	450	3551590133046	3551590133063	16,2	1,7	7,2	636	334	1,2590	600
	530	500	3551590133049	3551590133066	18,6	1,9	8,1	764	404	1,2476	700
1885	580	550	3551590133053	3551590133070	23,3	2,4	9,9	1020	543	1,2334	1000
	430	400	3551590133043	3551590133060	18,3	1,9	8,4	701	375	1,2236	700
	480	450	3551590133047	3551590133064	21,7	2,2	9,6	868	455	1,2631	700
2110	530	500	3551590133050	3551590133067	24,9	2,6	10,8	1014	532	1,2630	1000
	580	550	3551590133054	3551590133071	31,2	3,3	13,2	1317	706	1,2192	1200
	530	500	3551590133051	3551590133068	24,6	2,5	10,9	945	501	1,2436	900
730	580	550	3551590133055	3551590133072	28,3	2,9	12,3	1120	598	1,2293	1000
	730	700	3551590133056	3551590133073	35,6	3,8	15,0	1472	793	1,2113	1200

For output at different ΔT, please refer to the following formula: desired output = output at ΔT 50 x (desired Δt/50)ⁿ