

# Piano Lato



1260mm x 550mm in White RAL 9016 with White Cylinder valves

Dual Fuel options see pages 116-117



# Echo shown on page 95

Steel; Side loading towel rail, 50mm x 10mm flat tubes  
Can be installed left or right handed  
CE approved & certified to BS EN442

White RAL 9016 as standard, 188 RAL Colours and 30 Special Finishes  
Please call **01342 302250** for a RAL or Special Finish chart

**Stock White RAL 9016: 48-72 Hours**  
Made to Order sizes & colours: Up to 7 weeks White & White Electric,  
Up to 8 weeks Colours

### Stock options White RAL 9016- Hydronic

Height (mm)	Width (mm)	Model	Watts Δt 50°C	Btu's Δt 50°C
850	500	ECHO8550	585	1996
1110	500	ECHO1150	764	2607

Made to order options - Hydronic

Height (mm)	Width (mm)	Model	Watts Δt 50°C	Btu's Δt 50°C
655	500	ECHO6550	450	1535
	600	ECHO6560	506	1726
850	600	ECHO8560	655	2235
1110	600	ECHO1160	857	2924
1695	500	ECHO1650	1167	3982
	600	ECHO1660	1310	4470

Pipe centres left to right
50mm
Pipe centres from wall
57mm - 65mm
Depth from wall
112mm - 120mm

\*Saving based on the value of individual items when bought separately. Order any of our selected valves & matching pipe covers at the same time as your radiator; PROMOV3W (white), PROMOV3C (chrome).



Cylinder Valve Kit



**SAVE MONEY!** WHEN YOU BUY OUR **CYLINDER KIT** WITH ANY TOWEL RAIL ORDER\*  
QUOTE **PROMOV3** AT TIME OF ORDER

Available in White or Chrome

Made to order options - Electric

Height (mm)	Width (mm)	Model	Watts Δt 50°C
850	500	ECHO8550EW	600
	600	ECHO8560EW	600
1110	500	ECHO1150EW	800
	600	ECHO1160EW	800
1695	500	ECHO1650EW	1200
	600	ECHO1660EW	1200

Supplied as standard with a MOA Element

- 5 heat settings from 30°C to 60°C regulating internal radiator temperature,
- denoted by 5 LEDs. No Timer.
- Compatible with external Timer as remembers settings when turned off
- 55mm diameter clock shaped face.
- 4x Buttons: Temperature +/-, Dryer, Power. Frost & overheating protection.
- Straight cable, no plug. IPx5. Class I. Guarantee - 2 years.

# Piano Lato shown on page 97

High quality Italian design & manufacture  
Steel; side loading towel rail  
UKCA approved & certified to BS EN442

White RAL 9016 as standard, 188 RAL Colours and 30 Special Finishes  
Please call **01342 302250** for a RAL or Special Finish chart

**Stock White RAL 9016: 48-72 Hours**  
Made to Order sizes & colours: Up to 5 weeks



Cylinder Valve Kit



**SAVE MONEY!** WHEN YOU BUY OUR **CYLINDER KIT** WITH ANY TOWEL RAIL ORDER\*  
QUOTE **PROMOV3** AT TIME OF ORDER

Available in White or Chrome

Pipe centres left to right	Pipe centres from wall	Depth from wall
50mm	57mm - 67mm	80mm - 90mm

### Stock options White RAL 9016

Height (mm)	Width (mm)	Model	Watts Δt 50°C	Btu's Δt 50°C
1260	550	PIALAT1255	524	1788
1596	550	PIALAT1555	654	2231

\*Saving based on the value of individual items when bought separately. Order any of our selected valves & matching pipe covers at the same time as your radiator; PROMOV3W (white), PROMOV3C (chrome).

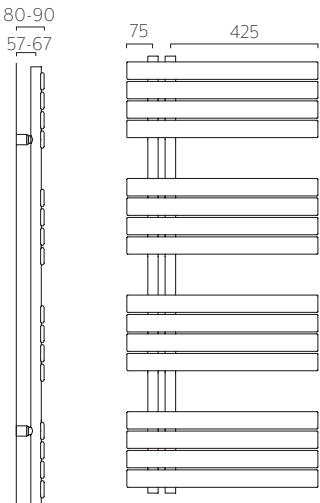



# PIANO LATO TOWEL RAIL

## Fitting Instructions

### Accessories not included

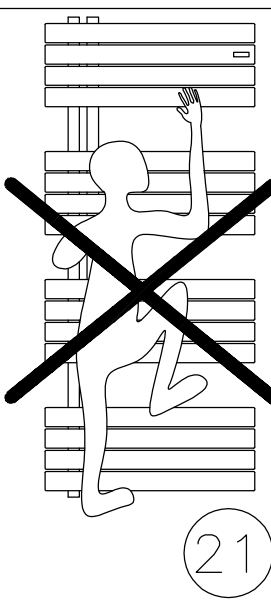
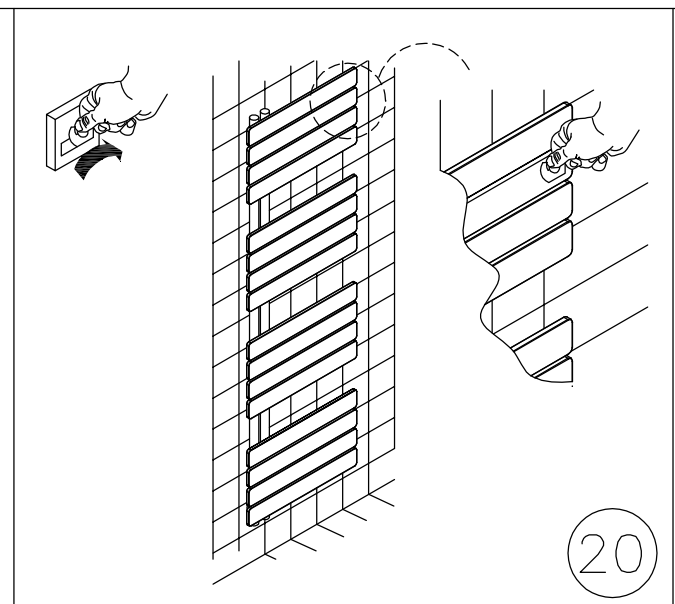
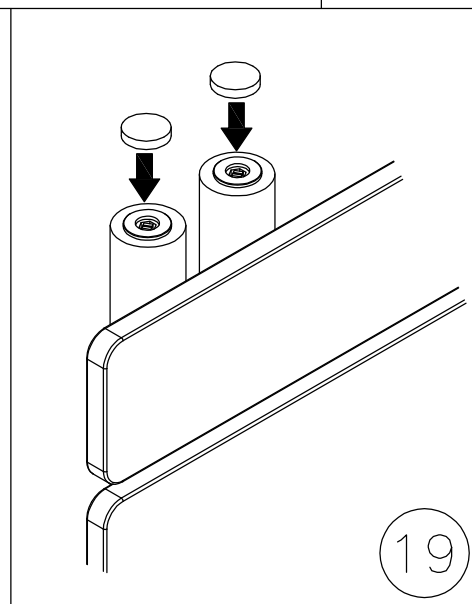
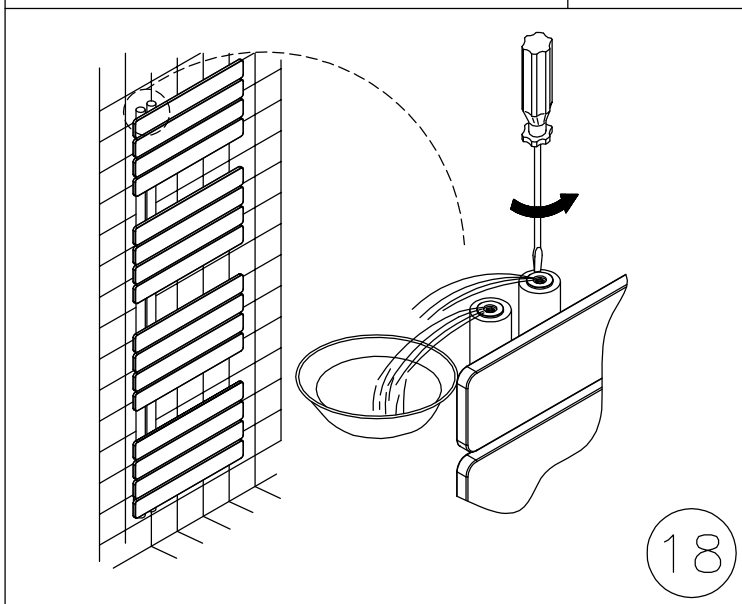
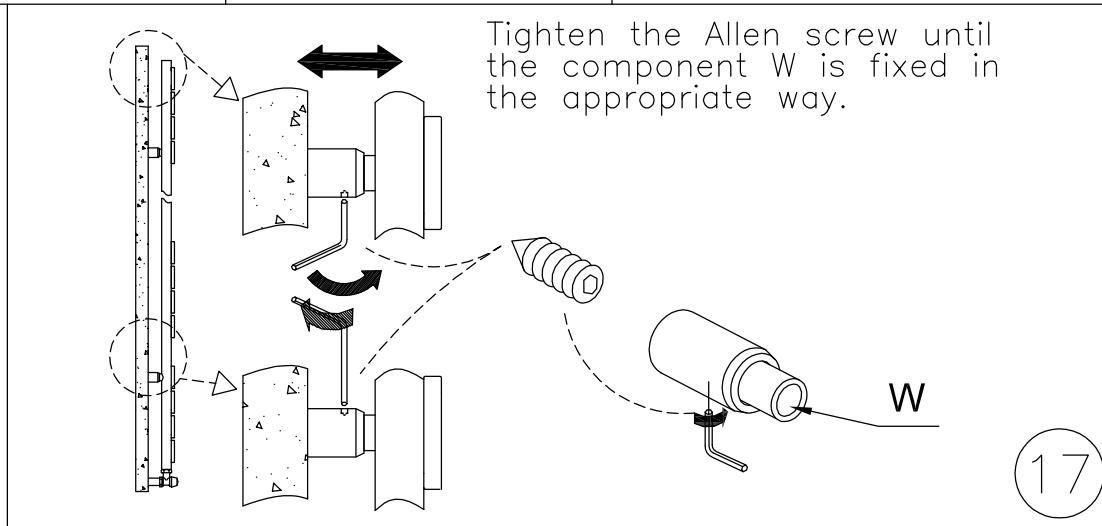
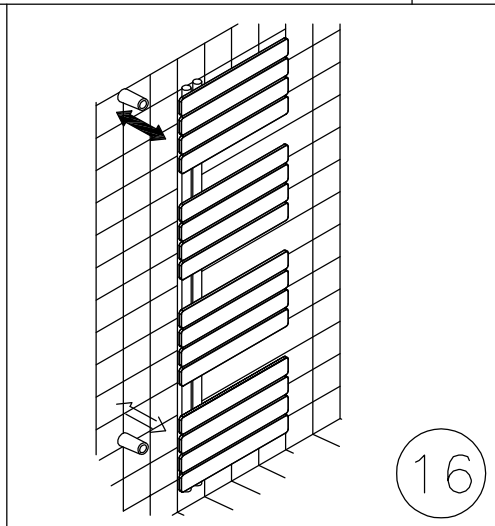
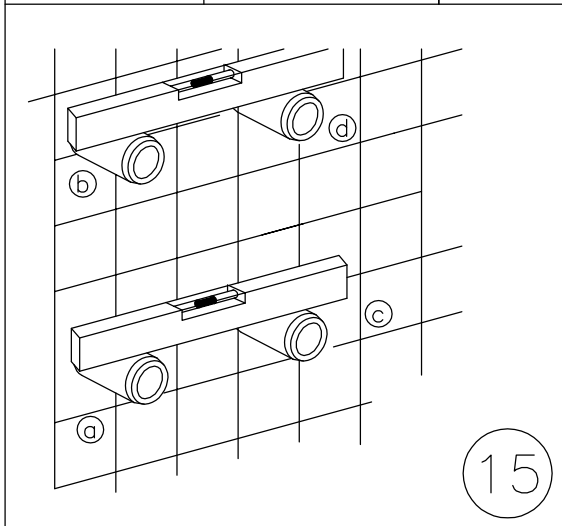
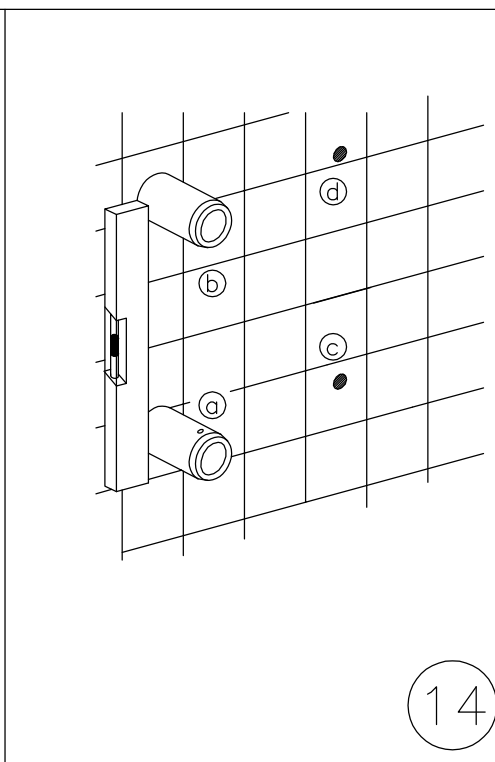
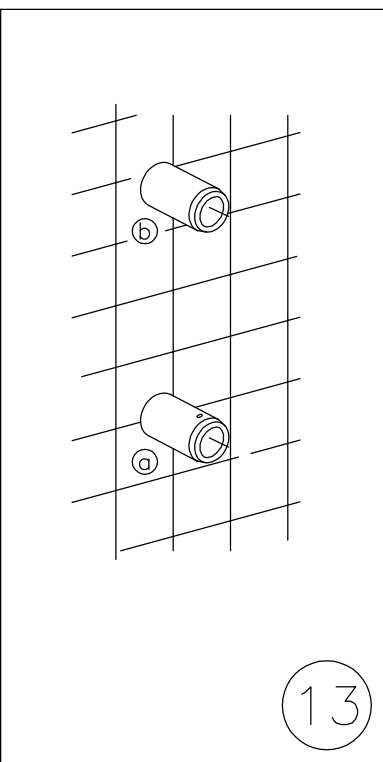
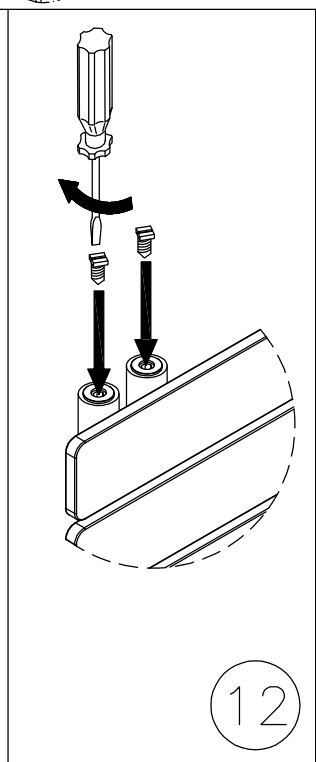
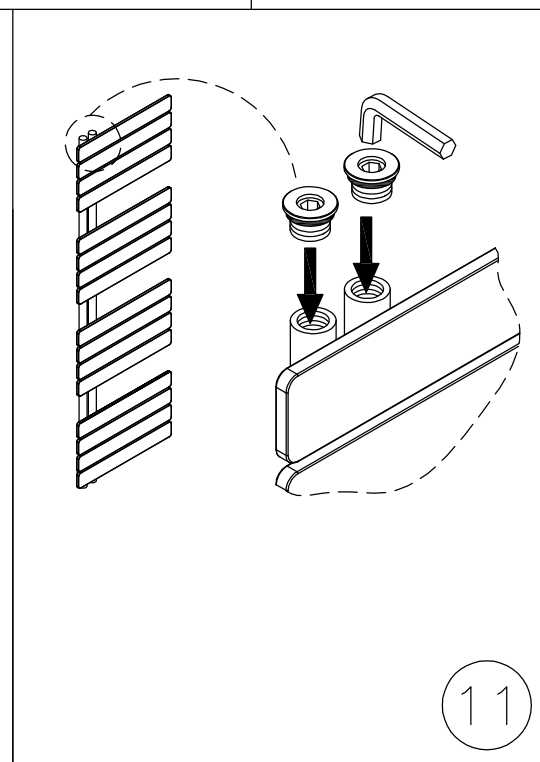
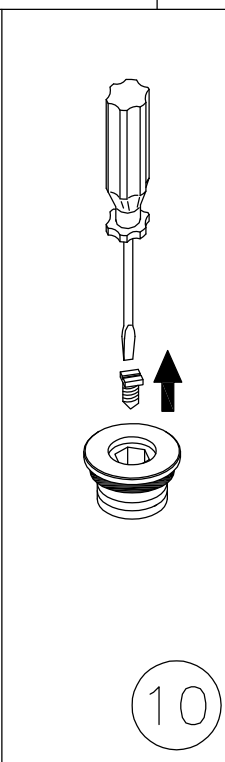
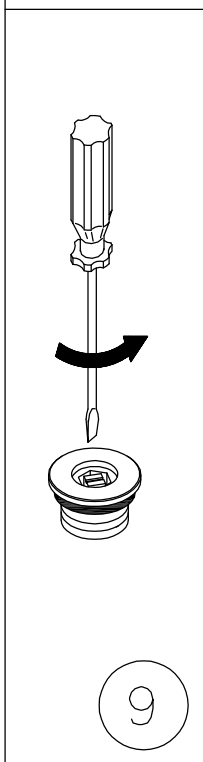
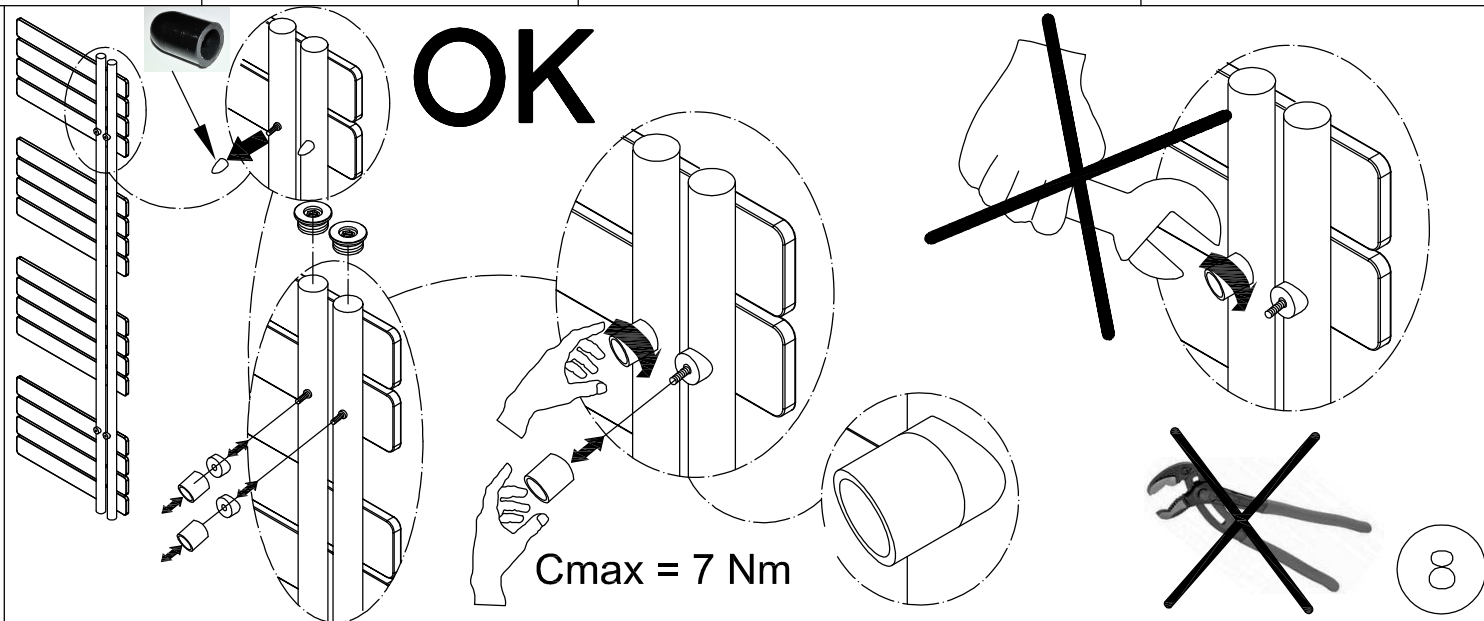
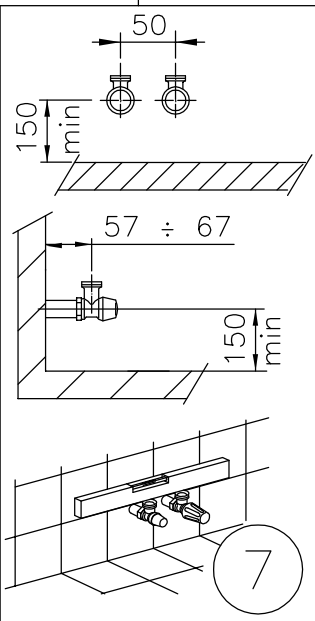
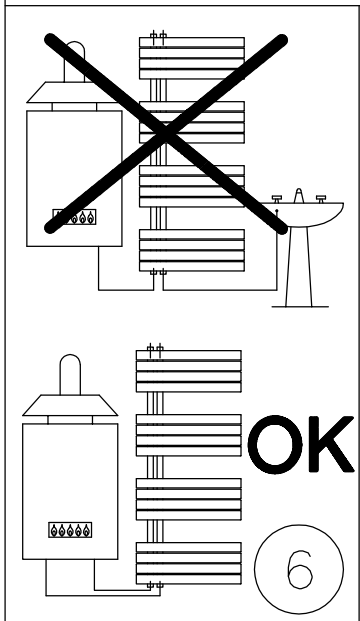
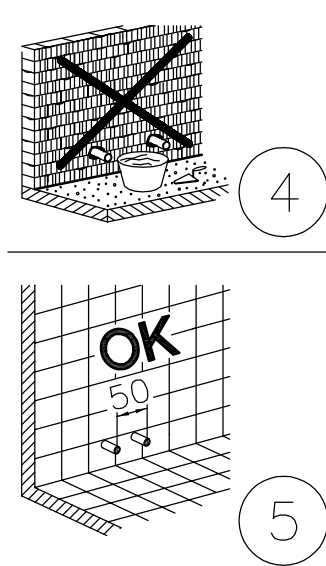
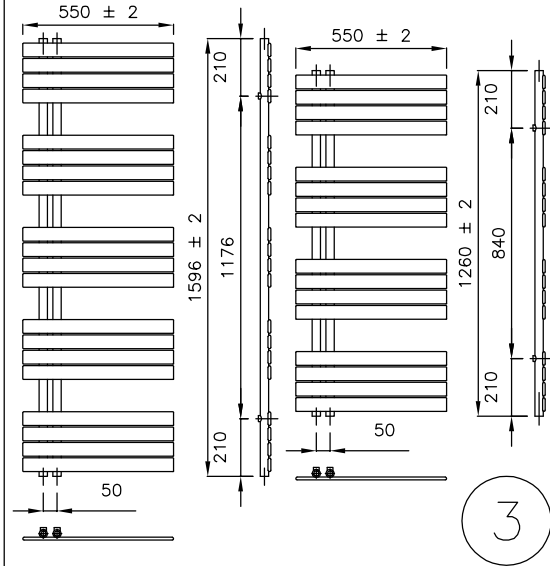
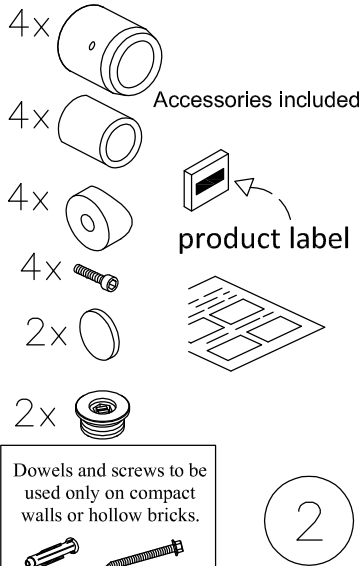
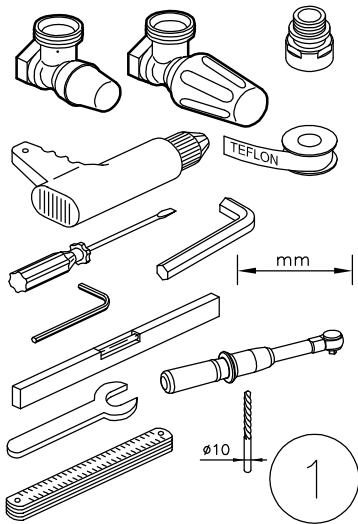

COMMISSION

Please Note: In accordance with Part L1 2006 of the Building Regulations and BS7593:1992 code of practice for the treatment of hot water and central heating systems, we strongly recommend flushing the heating system post installation of new radiators and then adding the correct quantity and type of inhibitor for use with your radiator and system to prevent corrosion. Damage caused to systems not protected by a suitable inhibitor will not be covered by manufacturer’s guarantee.

TECHNICAL SPECIFICATIONS

Materials	Mild Steel.
Connections	½ flow and return.
Test pressure	6 Bar
Testing authority	EN 442
Maximum operating pressure	4 Bar
Maximum working temperature	95°C
Packaging	Wrapped in polyethylene with cardboard box.
PLEASE NOTE: Systems using micro bore pipework must have adequate pressure and flow rates for the number and style of radiators on the system.	

TERMS & CONDITIONS

All products must be inspected once removed from the packaging and The Radiator Company notified within 28 days of delivery of any scratches, blemishes or other damage.

The Radiator Company will then replace the radiator.

Imperfect radiators should therefore not be fitted and The Radiator Company will not accept responsibility for replacement of scratched or damaged radiators once they have been fitted. This includes any consequential loss or cost of fitting.

If The Radiator Company are not notified within 28 days of the date on the signed delivery note then it will be deemed that The Radiator Company have fully complied with its obligations and claims will not be considered.

Failure to comply with any of the above may invalidate any claims.

We recommend that after you check the product on delivery that it is stored in its packaging to prevent damage prior to installation. The Radiator Company cannot accept responsibility for items damaged after delivery.

GUARANTEES & LIABILITIES

This product is guaranteed for 10 years . The guarantee is subject to the product being installed in accordance with British and or European standards as well as these fitting instructions. The guarantee in all cases are restricted to the free of charge replacement or repair of the failed product only. Our liability will under no circumstances extend beyond the repair or replacement of the product supplied by us. Claims for either labour in replacement or damage to property are not admissible. Any goods that are returned, in the event of a problem, will belong to The Radiator Company.

The Radiator Company  
Units 13 - 14 Charlwoods Road  
East Grinstead  
West Sussex  
RH19 2HU

A brand of **IRSAP** , Italy’s leading manufacturer of design led radiators.

If you have any questions please contact us on 01342 302250  
www.theradiatorcompany.co.uk